



2011-2012
AGENDA BOOK

TABLE OF CONTENTS

<u>SECTION</u>	<u>PAGE</u>
INTRODUCTION	
MESSAGE FROM THE ADMINISTRATION	9
HISTORY AND BACKGROUND	9
NOTICE OF NONDISCRIMINATION	9
IMPORTANT PHONE NUMBERS	10
BELL SCHEDULES	11-12
DISCIPLINE	13-25
TYPES OF DISCIPLINE	13-17
CODE OF INFRACTIONS & CONSEQUENCES	17-25
GUIDANCE SERVICES	26-35
STUDENT ASSISTANCE PROGRAM	34
EAGLE ACADEMY	34-35
GENERAL ATTENDANCE RULES & REGULATIONS	36-40
GENERAL INFORMATION	41-50
STUDENT ACTIVITIES	50-53
PHILOSOPHY	50
ELIGIBILITY	50-51
ACTIVITY PERIOD	51
TRIP CERTIFICATION	51-52
ATHLETIC PROGRAMS	52-53
STUDENT ACTIVITIES	53
SCHOOL CALENDAR	54
SCHOOL MAPS	55-56
ALPHABETICAL INDEX	57-59

JOSTENS

HELPING YOU REMEMBER AND
CELEBRATE YOUR
ACHIEVEMENTS FOR OVER
110 YEARS
WITH RINGS, YEARBOOKS,
AND CAP AND GOWNS

CONTACT YOUR REPRESENTATIVE AT THE SOUTH JERSEY SERVICE CENTER

JEFF JOHNSON

856-422-0217 Phone

854-422-0218 Fax

jeff.johnson.office@jostens.com



Magnum (A13): Shared ring 6216



**East Coast
Wholesale**

ACR

Atlantic County Rental

www.atlanticcountryrental.com

609-484-9200

3160 Fire Rd, Egg Harbor Township NJ 08234



MAYS LANDING

GOLF & COUNTRY CLUB

RESTAURANT AND LOUNGE
WATER WORKS

*640 Water Works Drive
Philadelphia, PA 19130
215.236.9000
www.thewaterworksrestaurant.com*



NATURALLY DELICIOUS

cell 973-975-3390



Dan Marx
Food Service Sales Manager

1-800-220-MILK

529 Cedar Lane
PO Box 146
Florence, NJ 08518
danmarx@creamoland.com

fax 973-543-7341

TRAINING WHEELS DRIVING SCHOOL

Behind The Wheel Instruction
Permits, Driving & Written Tests

Keith Cimaglia
Owner/Operator

48 S. New York Rd. Ste. A1
Galloway, NJ 08205
609-241-0118

Lic # 000-180



Egg Harbor Township Board of Education 2011-2012

Mr. James Galvin	President
Mr. Neil Anderson, Sr.	Vice President
Mr. Mark Deebold	
Mr. Louis Della Barca	
Mr. John "Jack" Haines	
Mr. Thor Himley	
Mr. James Kutch	
Mr. Brian Murphy	
Ms. Barbara Szilagyi	

Administration

Dr. Scott McCartney	Superintendent
Dr. Kimberly A. Gruccio	Assistant Superintendent
Mr. Donald Robertson	Assistant Superintendent
Ms. Kateryna Bechtel, CPA	Business Administrator/ Board Secretary
Ms. Joetta Surace	Director of Human Resources
Mr. Brett Charleston	Principal
Mr. Matthew Carey	Assistant Principal (A-G)
Ms. Lisa Heenan	Assistant Principal (H-O)
Mr. Glenn Robbins	Assistant Principal (P-Z)

INTRODUCTION

www.eht.k12.nj.us

WELCOME TO EGG HARBOR TOWNSHIP HIGH SCHOOL

Dear Students,

Our school is designed to encourage and assist each student in developing their abilities and aptitudes to the fullest potential for a most successful future. The student handbook is designed to provide information for students and parents regarding policies, procedures, and consequences for inappropriate behavior for students. The student handbook is not all inclusive and therefore does not contain every possible item or event that happens within the high school. Items not specifically addressed in the student handbook are therefore with be addressed via high school administration.

Your high school experience will include some of your fondest memories as you go through life. Take advantage of all the opportunities and services we have to offer you both academically and in co-curricular areas. This is a great high school, but with your involvement in many activities, you can make your high school even better. Get involved and make your high school experience a more rewarding one.

We would like to wish each student a happy and successful high school experience.

The High School Administration

THE SCHOOL CREST

The crest was designed for our high school. Each area has a specific meaning. In the upper left hand corner is a bell tower. This symbolizes education, as the bell tower was included in many school buildings including those in the Township. The farmers' plow is depicted in the right hand section of the crest. This represents the importance of agriculture in South Jersey and our own Township. The bottom of the crest is a ship representing the ship building industry that dominated the early economic development of this area. Atop the crest is an Eagle, which is the symbol and mascot for Egg Harbor Township High School. The official school colors are black and silver.

EGG HARBOR TOWNSHIP PUBLIC SCHOOLS NOTICE OF NONDISCRIMINATION

The Egg Harbor Township School District is committed to providing equal opportunity in education and in employment regardless of race, sex, marital or parental status, religion, age, national origin or physical/mental handicap. The District's policy of equal educational opportunity, including vocational education, is in compliance with the guidelines and requirements of Title VI of the Civil Rights Act of 1964, Title I of the Educational Amendments of 1972 and Section 504 of the Rehabilitation Act of 1973. Individuals with concerns, interests or inquiries into possible complaints are encouraged to contact:

Ms. Joetta Surace
Director of Human Resources
Egg Harbor Township Schools
13 Swift Drive

IMPORTANT PHONE NUMBERS

The official mailing address of the high school is:

Egg Harbor Township High School
24 High School Drive
Egg Harbor Township, NJ 08234-9450

Egg Harbor Township High School is: (609) 653-0100

The following extensions are:

- 1601 - Principal – Mr. Brett Charleston
- 1602 - Main Office
- 1604 - Assistant Principal - Mr. Matthew Carey
- 1606 - Assistant Principal - Mr. Glenn Robbins
- 1649 - Assistant Principal – Ms. Lisa Heenan
- 1612 - School Nurses - Ms. Sharon Beloff, Ms. Lee Ann Dragovits, and Ms. Christina Jones
- 1620 - Student Guidance Services
- 1621 - Supervisor of District Guidance Services – Dr. Terry Charlton
- 1630 - Student Assistance Counselor – Ms. Staci DiMattia
- 1641 - Attendance Lobby – Sign-in & Sign-out
- 1661 - Athletic Director – Mr. Michael Pellegrino
- 1670 - Youth Study Team
- 1693 - Attendance Secretary - Ms. Jennifer Williams
- 927-2443 Transportation - Mr. Warren “Skip” Fipp
- 926-9483 Homebound Instruction

2011 – 2012 DAILY BELL SCHEDULE

Time	4 Day	3 Day	2 Day	1 Day
7:30	Warning Bell	Warning Bell	Warning Bell	Warning Bell
7:35 - 8:30	Period 4	Period 3	Period 2	Period 1
8:34 - 9:29	Period 1	Period 4	Period 3	Period 2
9:33 - 10:35 (Homeroom 7 minutes)	Period 2	Period 1	Period 4	Period 3
10:39 – 11:34 11:38 - 12:08	Period 8A 2 nd Lunch	Period 7A 2 nd Lunch	Period 6A 2 nd Lunch	Period 5A 2 nd Lunch
10:39 - 11:09 11:13 - 12:08	1 st Lunch Period 8B	1 st Lunch Period 7B	1 st Lunch Period 6B	1 st Lunch Period 5B
12:12 - 1:07	Period 5	Period 8	Period 7	Period 6
1:11 - 2:06	Period 6	Period 5	Period 8	Period 7

2011 – 2012 ½ DAY BELL SCHEDULE

Time	4 Day	3 Day	2 Day	1 Day
7:30	Warning Bell	Warning Bell	Warning Bell	Warning Bell
7:35 - 8:11	Period 4	Period 3	Period 2	Period 1
8:15 – 8:51	Period 1	Period 4	Period 3	Period 2
8:55 – 9:38 (Homeroom 7 minutes)	Period 2	Period 1	Period 4	Period 3
9:42 – 10:18	Period 8	Period 7	Period 6	Period 5
10:22 – 10:58 11:02 - 11:32	Period 5A 2 nd Lunch	Period 8A 2 nd Lunch	Period 7A 2 nd Lunch	Period 6A 2 nd Lunch
10:22 – 10:52 10:56 - 11:32	1 st Lunch Period 5B	1 st Lunch Period 8B	1 st Lunch Period 7B	1 st Lunch Period 6B
11:36 – 12:12	Period 6	Period 5	Period 8	Period 7

DISCIPLINE

IT IS THE STUDENT'S RESPONSIBILITY TO BECOME FAMILIAR WITH ALL INFORMATION IN THE STUDENT HANDBOOK.

The Board of Education of the Egg Harbor Township School District will ensure the safety and welfare of students while in the school building. Each student is expected to conduct himself in an orderly fashion and act with due regard for the educational process of the school. ***Egg Harbor Township High School is a Zero Tolerance High School for Drugs, Alcohol, Weapons, and Violence.***

The best discipline is self-discipline, and students are encouraged to think and act wisely and realize the consequences of all actions. When students fail to discipline themselves, they shall be turned over to the designated administrator, personnel, or civil authority.

Teachers are primarily responsible for classroom management and discipline in their assigned classes and duties. All staff members share responsibility for supervising the behavior of students. All students must follow any reasonable request or directive by any staff member during the school day or at any school sponsored activity.

The following are types of discipline that may be enacted.

***** PLEASE NOTE: Students that fail or refuse to serve assigned discipline will immediately lose all privileges including, but not limited to, sports, activities, clubs, and/or other school events until the discipline is served.***

- 1. TEACHER DETENTION:*** Teachers are encouraged to make parental contact concerning discipline problems. Teachers are encouraged to use detention after exhausting other avenues such as individual counseling. Teachers may issue detentions. Pupils are to be given 24 hours' notice of the detention and issued a detention form. Pupils will receive a copy of their detention form. It is the pupil's responsibility to inform their parent and/or guardian about the detention.

Pupils will report to the assigned room for detention immediately following the last class of the day and will remain there under supervision until dismissed.

Pupils who fail to report for their teacher detention will be issued an additional detention and have the original detention rescheduled. Pupils who fail to report a second time will be referred to the appropriate Assistant Principal and a Saturday Detention will be issued.

- 2. CENTRAL DETENTION:*** This form of detention is issued to pupils involved in a serious offense. Central detentions are conducted after school and are issued by the Assistant Principals or Principal. Pupils must report for detention on the day assigned and will be expected to bring work to the detention. Detention is a disciplinary situation. Lounging, talking, card playing or the like will not be tolerated. Failure to meet a detention obligation is a serious violation of school responsibilities and will be dealt with appropriately. Students who are removed from central detention and/or miss a central detention will receive progressive discipline including, but not limited to a Saturday Detention. Students that consistently miss central detentions will be subject to losing certain privileges, including but not limited to the following: attendance at school dances, trips, prom, participation in athletics, etc.

When a pupil is legally absent from school on the day of a scheduled central detention, they must serve on the next day central detentions are held.

- 3. Saturday Detention (see the following for detailed information regarding this type of discipline)***

Egg Harbor Township High School

Saturday Detention

The purpose of Saturday detention is to provide a positive, worthwhile, educational experience and a meaningful misbehavior deterrent for students who have violated school rules.

Saturday detention may be used as a disciplinary tool in lieu of Alternative Educational Placement/ Suspension. This option will keep students from losing instructional time and keep them in school Monday thru Friday. Refusal to attend or tardiness without an acceptable excuse will result in an additional detention and/or suspension from school.

Saturday detention has three components: detention, academic assistance and behavior modification.

Students will receive academic assistance and will have the opportunity to do homework, make-up or remedial work under the supervision of three certified teachers, who will provide academic assistance, as well as, supervision. Each student will receive a Behavior Modification Packet, which will consist of writing an introspective essay to help students understand why they broke school rules and the consequences of their misbehavior. The packet will also include a goal-setting exercise and a list of Character Education words to be defined and used in a reflective sentence.

2011-12 Saturday Detention Schedule: provisions will be made for thirty (30) sessions.

- Sept. 24
- Oct. 1, Oct. 15, Oct. 22, Oct. 29
- Nov. 12, Nov. 19
- Dec. 3, Dec. 10, Dec. 17
- Jan. 7, Jan. 14, Jan. 24, Jan. 28
- Feb. 4, Feb. 11, Feb. 18, Feb. 25
- Mar. 3, Mar. 10, Mar. 17, Mar. 24, Mar. 31
- Apr. 21, Apr. 28
- May 5, May 12, May 19, May 26
- Jun. 2

Detention Rules

- Assistant Principal assigns students for disciplinary reasons, as per the Student Handbook.
- The parent notification will be the responsibility of the Assistant Principal.
- If an emergency arises and the student cannot attend, the parent must contact the Assistant Principal. If the reasons are acceptable, the detention will be rescheduled.
- The doors will open at 7:45 a.m. and close at 8:00 a.m.

- Students must have some type of assignment to work on. (Homework, make-up work or remedial work is allowed.) There are no electronic devices, food, beverage, candy, etc. allowed in the Saturday Detention Room.
- There will be no talking.
- Breaks for a drink or restroom use are at the discretion of the detention supervisor.
- Students will complete a Behavior Modification Packet.
- If a student finishes all of his or her work, the detention supervisor will assign additional work.
- If a student refuses to work, he/she will be removed by the site administrator.
- Should a student have an unexcused absence from a Saturday Detention, he/she will be assigned one day of Out of School Suspension, plus attend the next scheduled Saturday Detention. A second unexcused absence to an assigned Saturday Detention will result in a two day out-of-school suspension beginning on the following Monday, plus attend the next Saturday Detention, loss of all privileges and a parent conference upon returning from suspension.
- Students will be expected to work the entire time while there. Any student not working may be removed from the room and referred to the building administrator. No student is permitted to sleep during Saturday Detention.
- Any student acting disruptively will be removed from the Saturday Detention and be referred to the building administrator for further disciplinary action.

Operational Procedures

- The Saturday Detention Program operates at the Egg Harbor Township High School, 24 High School Drive (Detention will be held in the Upper Cafeteria).
- The program runs from 8 a.m. to noon.
- The District is ***not*** responsible for transportation of student to or from Saturday Detention.
- Assistant Principal's may assign students from Monday through Thursday. No assignments will be made on Friday for that Saturday.

4. ***ALTERNATIVE EDUCATIONAL PLACEMENT (AEP)***: AEP is a serious disciplinary situation and will be handled as such. It is important that all the rules and regulations below are followed.

AEP Rules and Regulations

- a. Report to the appropriate room. Do NOT bring coats or hats to AEP.
- b. Pupils must bring textbooks, paper, pencils, etc. with them. Assignments will be sent to the pupils by their classroom teachers. Pupils must place their name and their teacher's name on all completed work. Pupils who fail to complete work assignments will receive a zero for that work.
- c. Pupils will not be permitted to leave AEP to go to their locker, pep rallies, assemblies, etc.

- d. Talking, lounging or playing cards and electronic devices are prohibited.
 - e. Pupils may leave the AEP room only if they receive direct permission from the supervising teacher.
 - f. Provisions will be made for lunch. Pupils are encouraged to bring their lunch. ***Lunch can only be brought with a student in the morning.***
 - g. Pupils will remain in AEP for the entire day.
 - h. If a pupil is absent on the day of AEP, they must make up the time the very next day they return to school.
 - i. The conditions of suspension of out-of-school also pertain to AEP. This means pupils are not permitted to attend or participate in any school activities during the days they are assigned AEP.
 - j. Pupils who fail to attend AEP for reasons other than absence will result in out-of-school suspension and possibly making up the missed day of AEP, and/or the loss of certain privileges, including but not limited to athletics, activities, and other school sponsored events.
 - k. Failure to follow these rules will result in further disciplinary action.
 - l. If it is necessary for the AEP pupil to be removed from the AEP room, pupil will be sent home and suspended out of school.
 - m. Pupils will not be allowed to sleep during AEP and after two warnings the pupil will be referred to the Assistant Principal's office.
5. **OUT-OF-SCHOOL SUSPENSION:** This is a serious disciplinary sanction, which may be imposed against a pupil when it can be proven that the pupil has interfered with the maintenance of the good order of the school. The pupil may not be permitted to return to school until a parent conference, either in person or via the phone is conducted. Out-of-school suspension may be used for a student who is a continual behavior problem. This will be referred to as "progressive discipline".

PUPILS ARE REMINDED THAT THEY ARE RESPONSIBLE FOR ALL WORK MISSED AS A RESULT OF A DISCIPLINARY ACTION. Pupils should also note that any disciplinary action takes precedence over previously scheduled activities such as clubs, athletics or school work programs. ***Additionally, when a pupil is suspended from school, he / she may not be in the building or on any school district grounds, including other schools, at any time during the length of the suspension. Students who fail to comply may face trespassing charges with the EHTPD.*** Pupils who are suspended out of school may NOT participate in any school function for the duration of the suspension. This includes athletic contests, class trips, dances, work study programs, and club activities.

Parents will be contacted in most cases involving Assistant Principal intervention.

6. **PROBATION AND/OR BEHAVIORAL CONTRACTS:** Students may be placed on probation and / or a behavior contract if: (a) they have an accumulation of minor violations or (b) commit a serious offense.

Probation /behavior contracts will outline strict standards that the student is expected to follow. During the period of time that a pupil is placed on probation/behavior contract, it is understood that he or she must meet all outlined standards. Failure to meet the standards established by probation / behavior contract will result in further, more severe disciplinary procedures, including but not limited to loss of a

privileges (school activities, trips, school dances, prom, and/or graduation), and/or consideration for alternative placement.

All offenses committed in school or on the school grounds that violate local, state or federal laws will be referred to the police for appropriate action. Continued discipline problems and acts that endanger the health, safety and welfare of pupils, parents, and/or faculty may require the school administration to take further action. Such action may include, but not be limited to, referral to the police.

Students who are on **NO CREDIT STATUS** and/or students who consistently require disciplinary intervention by the assistant principal and subsequently amass a lengthy discipline history will be subject to losing certain privileges, including but not limited to the following:

- Participation in school activities such as: athletics, clubs, after school events (such as EHT Idol, school dances, or Mr. EHT), trips, prom, and/or attendance at senior activities and commencement exercises

DISCIPLINARY CODE OF INFRACTIONS AND CONSEQUENCES

The consequences or disciplinary actions listed below will be imposed on a case-by-case basis. In situations where extraordinary circumstances exist, a determination other than that listed below may be imposed. All students will receive due process. The items in the disciplinary code of infractions apply to all school sponsored activities.

1. **ACTIVITY PERIOD:** Pupils are not permitted to remain after school for the activity period unless they are under the supervision of a teacher or coach.

First offense: 3 Central Detentions.

Second offense: 30-day suspension of activity period privileges and parent contact.

Students who do not immediately report to the Assistant Principal after missing the bus or waiting for their ride and found unsupervised will be assigned 3 central detentions.

2. **AUTOMOBILES:** Any pupil driving unauthorized to drive to school will be issued a Saturday detention and any unauthorized pupil passenger will receive a Saturday Detention. Pupils may not drive to school if they miss their bus.

First offense: Warning about towing (sticker), Saturday Detention, parent contact (phone, letter).

Second offense: Warning about towing (sticker), Saturday Detention, parent contact (phone, letter).

Third offense: Towing at owner's expense, Two Saturday Detentions, and parent contact (phone, letter)

3. **CAFETERIA/COMMONS AREA:**

- a. Late to cafeteria will result in a central detention.
- b. Cutting in lunch line will result in a central detention.
- c. Leaving the cafeteria/commons area without permission will result in the student being assigned a minimum of, but not limited to, one central detention.
- d. Misbehavior in the cafeteria/commons area and/or throwing food or trash, or leaving trash or littering will result in student being assigned a minimum of, but not limited to, one central detention.

4. **Communication Devices**

Cellular phones and any other mobile communication device must be turned off and placed in the student's locker or book bag during school hours. Students may not use these devices, nor can they be visible. If seen, students should be referred to the appropriate assistant principal.

- 1st Offense: Administrative Warning
- 2nd Offense: minimum of, but not limited to, central detention(s)
- 3rd Offense: Discretion of Administrator (Notify Parent/Guardian)

5. **COMPUTER MISUSE:** Computer access is granted to individual pupils for their sole use only. Violation may result in a loss of access as well as other disciplinary or legal action. The following are not permitted: sharing of accounts, ID's, or passwords; adding any unauthorized software; sending or displaying of offensive messages or pictures; using obscene language; harassing, insulting, or attacking others; damaging computers, computer systems, or computer networks; violating copyright laws; using another's password; trespassing in another's subdirectories, work, or files; intentionally wasting limited resources; employing the network for commercial purposes.

A. Sharing of accounts, passwords, changing desktop, sending messages, trespassing in another's subdirectory or work files, using the computer to convey obscene language or pictures and using the network for commercial purposes; intentionally wasting limited resources such as paper; violating copyright laws:

- First Offense: 3 central detentions
- Second Offense: Saturday Detention
- Third Offense: Minimum Saturday Detention /Loss of computer privilege

B. Harassing, insulting or attacking others, will result in an immediate loss of computer privileges. Please see Harassment, Intimidation, Bullying and Fighting.

C. Intentionally damaging computers, systems or networks:

Out-of-school suspension - restitution for damage

6. **CONDUCT POTENTIALLY DANGEROUS TO ONE'S SELF OR OTHERS:** Including but not limited to: near fight, throwing snowballs, food and water balloons, the use of water pistols, wrestling, play fighting, disruptive behavior, disorderly conduct, and/or simple assault.
- Minimum, but not limited to, one Saturday Detention
 - Maximum ten-day suspension/parent conference
 - Disorderly conduct and/or assault charges may be filed with the E.H.T.P.D.

7. **Dress Code:**

Short shorts and/or skirts, Tank tops, halter-tops, bathing suits, see through or mesh tops, or any other clothing that will reveal the body or reveal underwear may not be worn in school. Bare midriiffs are not acceptable. Student shoulders may not be visible. Also please refer to Dress Code Policy on page 42 of this handbook for more detail.

- First Offense: Minimum of, but not limited to, two Central Detentions
- Second Offense: minimum of, but not limited to, Saturday Detention

Third Offense: At the Discretion of the Administrator; repeat offenders will receive progressive discipline

8. DISRESPECT/DEFIANCE OF AUTHORITY/CONTINUED WILLFUL DISOBEDIENCE

- Minimum of, but not limited to, one Saturday Detention.
- Maximum of ten day suspension/parent conference

9. DRUG & ALCOHOL POLICY AND PROCEDURES (Policy 5530):

The use, possession, and/or distribution of alcoholic beverages, controlled dangerous substances, drug paraphernalia, anabolic steroids, inhalants, unauthorized prescription drugs, or over-the-counter medications are strictly prohibited. The student will serve a ten-day out of school suspension for substance use, possession, and/or distribution or for a positive drug/alcohol screening.

- A. Any student found to be in possession of drug paraphernalia will be suspended out of school for up to ten (10) days. The police will be notified and complaints may be signed. A parent or guardian conference is mandatory, and students must meet with the SAC after they return. The student may also have to appear before the Discipline Review Committee of the Board of Education.
- B. Any student found to be in possession of controlled dangerous substances and/or alcohol will be immediately suspended ten (10) days out of school. The police will be notified and complaints will be signed. A parent or guardian conference is mandatory, and students must meet with the SAC after they return. The student may also have to appear before the Discipline Review Committee of the Board of Education
- C. Any student found to be distributing controlled dangerous substances, alcohol, prescription drugs, over-the-counter medications, and/or counterfeit drugs will be immediately suspended up to ten (10) days out of school. The police will be notified and complaints may be signed. A parent or guardian conference is mandatory, and students must meet with the SAC when they return. The student may also have to appear before the Discipline Review Committee of the Board of Education.
- D. Any student found to be in possession of counterfeit drugs, over the counter medications and/or prescription drugs not registered with the school nurse will be suspended a minimum of four (4) days out of school. A parent or guardian conference is mandatory before the student returns to school. Subsequent offenses will result in further disciplinary action.
- E. When a pupil is suspected of being under the influence, staff must notify the nurse or SAC who will then notify the Principal or designee, who immediately contacts a parent, the Superintendent and the physician or medical examiner for a drug screening by use of a urine sample. Parent may select a physician other than the school physician or medical examiner, but such an examination shall not be at the expense of the district Board of Education. If available, parent may accompany pupil to medical facility for examination. Parent will be given a copy of chemical screening form, NJAC 6:29-6 and medical readmission form. If there is a positive diagnosis of alcohol or other drugs, the pupil shall not resume attendance at school until a written report has been submitted to the Principal from a physician who has examined the student, and can certify that substance abuse no longer interferes with the pupil's physical and mental ability to perform in school. Refusal or failure by a parent or guardian to comply with the provisions of the Code and Policy shall be deemed a violation of the compulsory education and/or the child neglect laws. Sanctions will be the same as those imposed for students who test positive for drugs or alcohol.
 - 1. The Student Assistance Coordinator will meet with the student and parent to ascertain current treatment needs, and to formulate appropriate recommendations for follow-up.

2. Periodic urine screenings for a calendar year will be arranged by the nurse in coordination with the SAC and must be completed within 24 hours. Positive results will warrant referral for more intense treatment. Failure to comply will result in an appearance before the Principal.
 3. A diluted, altered or contaminated specimen will result in further testing and suspension for not following Board Policy.
 4. Students who test positive for drugs or alcohol as a result of a second administrative referral or use again will be suspended and may have to appear before the Discipline Review Committee of the Board of Education and may be sent to Eagle Academy (alternative school).
- F. Any pupil suspected of being under the influence of any of the above on school property or at any school sponsored event shall immediately be taken through the mandated steps as outlined in the New Jersey Administrative Code, Title 6A: 16-6.1 and the E.H.T. Board of Education Policies and Procedures. These include immediate notification of the Administration, parents, and Superintendent and immediate referral to a medical facility for examination and drug screening.

10. **FAILURE TO FOLLOW PROCEDURE** This includes failure to obey school rules as outlined in this handbook.

First Offense: Minimum of two Central Detentions

Second Offense: Saturday Detention

Third Offense: At the Discretion of the Administrator

11. **FALSE ALARMS:** Initiating a false alarm is a dangerous and serious action. A student guilty of such an offense endangers others and is in violation of the law. Such an individual will be suspended for ten days and may be referred for additional disciplinary action. A complaint may also be signed with the E.H.T.P.D.

12. **FIGHTING:** see #16 - Harassment, Intimidation, Bullying and Fighting

13. **FIREWORKS:** The possession and/or use of fireworks are serious infractions. Suspensions will be issued and complaints may be signed with the Egg Harbor Township Police Department.

14. **FORGERY:** Forgery and/or unauthorized possession of school forms:

First Offense: One Saturday Detention

Second Offense: Two Saturday Detentions

15. **GRAFFITI:** The defacing of school property in this manner will be treated as a serious offense. Any pupil having done so will be issued an immediate ten (10) day out-of-school suspension. Arrest and complaints may be signed with the Egg Harbor Township Police Department.

16. **HARASSMENT, INTIMIDATION, BULLYING AND FIGHTING:**

(Also see School Board Policy 55.12.01)

Harassment, intimidation, bullying and fighting are prohibited (N.J.S.A. 18A: 37-15(3) (b) (1)).

“Harassment, intimidation or bullying” means any gesture or written, verbal or physical act that is reasonably perceived as being motivated either by any actual or perceived characteristics such as race, color, religion, ancestry, national origin, gender, sexual orientation, gender identity or expression, or a mental, physical or sensory handicap, or by any other distinguishing characteristics that takes place on school property. At any school-sponsored function or in a school bus and that:

- a. a reasonable person should know, under the circumstances, will have the effect of harming a student or damaging the student’s property, or placing a student in reasonable fear of harm to his person or damage his property; or
- b. has the effect of insulting or demeaning any student or group of students in such a way as to cause substantial disruption and/or interference with, the orderly operation of the school (N.J.S.A. 18A: 37-15(3)(b)(2)).

This includes but is not limited to:

- a. Verbal: name-calling, teasing, threatening, taunting and gossiping.
- b. Emotional: shunning, isolating, rejecting, terrorizing, extorting, defaming, humiliation, blackmailing, manipulating friendships, initiating rumors and extorting coercive peer pressure.
- c. Physical: aggressive physical contact, including punching, poking, shoving, kicking, choking, hair-pulling, beating, biting and tickling.

The Egg Harbor Township High School Administration expects students to conduct themselves in a mature manner, conform to reasonable standards of socially acceptable behavior, and to respect other students, school faculty and staff, the educational purpose underlying all school activities, and the care of school facilities and equipment.

All school employees, students, parents, volunteers and visitors are encouraged to report any act that may be a violation of this policy to the high school administration. The administration will conduct a prompt, thorough and complete investigation of the alleged incident and determine whether an act constitutes a violation of this policy. Consequences and appropriate remedial action for students who commit acts of harassment, intimidation, bullying and fighting may range from positive behavioral interventions up to and including central detention, Saturday detention, suspension or expulsion (N.J.S.A. 18A: 37-1). In addition, serious acts will be reported to the E.H.T.P.D. (NJAC 6A: 16-6,z(b)12) and complaints will be signed.

The Egg Harbor Township High School Administration prohibits reprisal or retaliation against any person who reports an act of harassment, intimidation, bullying or fighting. The consequence and appropriate remedial action for the offender shall range from central detention to out-of-school suspension or expulsion. Complaints may be signed by the EHTPD.

Consequences and appropriate remedial action for a student found to have falsely accused another as a means of harassment, intimidation, bullying, or fighting range from positive behavioral interventions up to and including detention, suspension, or expulsion, as permitted under N.J.S.A. 18A: 37-1, Discipline of pupils.

17. IDENTIFICATION BADGES / MONTHLY HALL PASS: All students are required to carry or wear an identification badge and monthly hall pass during school hours. Failure to carry or wear an ID badge or hall pass could result in Central Detention, Saturday Detention, or Out-of-school suspension.

1. Identification badges must be displayed to gain access to the following places:
Media center, cafeteria (register area), sporting events, and school sponsored activities

2. Any falsification, damage to and/or stealing an ID / hall pass will result in disciplinary action deemed appropriate by the Assistant Principal.
3. If a student loses an ID badge / hall pass, he/she should report to his/her assistant principal's office for a new ID badge. New IDs cost \$5.00. New hall passes cost \$2.00.

18. ILLEGAL ABSENCE FROM CLASS:

<u>1st offense</u>	3 Central Detentions/written notification
<u>2nd offense</u>	Saturday Detention / written notification
<u>3rd offense</u>	Saturday Detention / Parent contact
<u>4th or more offenses</u>	Saturday Detention & loss of credit for entire year or mandatory credit completion

Any illegal absence will result in a "0" in that class. Work cannot be made up.

The Administration firmly believes in the importance of attending all regularly scheduled classes during the school day to receive credit for that course. A student will be considered "illegally absent" from class if they do not receive the permission from classroom teacher whose class they are missing and/or permission from administration.

Further, if a student exceeds three cuts (in one class or three total) the student will, in addition to Saturday Detention, lose all credits for courses passed during the current school year. These credits can be regained only by attending summer credit completion. One day of credit completion will be required for each cut in excess of three. PLEASE NOTE: A student can have one incident that results in three cuts. One incident that exceeds three cuts will automatically place a student on NO CREDIT STATUS and the cost of credit completion will be at the parents' expense.

- 19. LATENESS TO CLASS:** Students late to class will receive one teacher detention, then that will be doubled automatically if the student fails to report. If the student fails to report for the first of the now two detentions, he/she will be referred to the appropriate Assistant Principal and a Saturday Detention will be assigned. After twelve times late to class, the student will receive a minimum of one Saturday Detention, up to a maximum of out of school suspension for "excessive lateness".

- 20. LATE SIGN-IN & EARLY SIGN-OUT:** IMMEDIATELY upon entering the building, students late to school must sign in at the Attendance Office. Failure to do so will result in three Central Detentions and/or a Saturday Detention (see #10 Failure to Follow Procedure). Students will be given a pass to class at the time of sign-in. STUDENTS MUST SIGN IN BEFORE THE END OF 2nd BLOCK (9:29 a.m. TO RECEIVE CREDIT FOR THE DAY. STUDENTS MUST ALSO BE PRESENT FOR AT LEAST FOUR PERIODS IN ORDER TO RECEIVE CREDIT FOR A FULL DAY. Students must be present 4 1/2 hours in order to be considered present for a day. Senior Early Release students must be present for one half of their scheduled classes in order to receive credit for a day.

The following reasons are considered excuses for lateness or early sign out:

- A. An appointment with a physician.
- B. A driver's test. Verification is required.
- C. A mandated court appearance.

Students should not make a habit of signing in late or signing out early. Students who sign in or sign out for any other reason risk being placed on NO CREDIT STATUS for any class they miss more than fourteen (14) times. Remember, students on NO CREDIT STATUS will be subject to losing certain privileges and will have to attend credit completion, if offered, in order to receive credit for those classes missed more than fourteen (14) times.

- 21. LEAVING CLASS WITHOUT PERMISSION:** A pupil will receive a minimum of, but not limited to, three

central detentions for removal from class or leaving class without permission. Students who leave school without permission will be considered truant (see #33 Truancy).

- 22. LOITERING:** Students are not permitted to loiter in the hallways, especially between classes (see #10 Failure to follow procedure). This includes congregating in groups, meeting in the halls/lockers. Students are required to go to class at the sounding of the bell.
- 23. MACE** Students may not be in possession of mace or mace like products in school. It is a violation of New Jersey State Statutes for anyone under the age of 18 to be in possession of these type products as well. These products will be confiscated. Violations involving the spraying of these products will result in a minimum of, but not limited to, a four (4) day out-of-school suspension and a complaint will be signed with the Egg Harbor Township Police Department.
- 24. MISCONDUCT/DISRUPTIVE BEHAVIOR:** - Minimum of, but not limited to, two central detentions.
- 25. MISUSE OF A HALL PASS:** Any student caught abusing a hall pass (i.e. using a pass for reasons other than its written intent) will receive:
- first offense – minimum of, but not limited to, one central detention
 - second offense – minimum of, but not limited to, three central detentions
 - third offense – minimum of, but not limited to, one Saturday Detention
- 26. PROFANITY:** Use of Profanity
- | | |
|----------------|--|
| First Offense | Minimum of, but not limited to, two central detentions |
| Second Offense | Minimum of, but not limited to three central detentions. |
- 27. RACIAL OR ETHNIC SLURS:** The use of racial or ethnic slurs is unacceptable. Pupils may be issued a minimum of, but not limited to a Saturday Detention.
- 28. REMOVAL FROM SATURDAY DETENTION:** Any student acting disruptively will be removed from the Saturday Detention and be referred to the building administrator for further disciplinary action.
- Minimum of, but not limited to, one day suspension (in addition to the Saturday detention make-up day)
 - Maximum of ten day suspension/parent conference(in addition to the Saturday detention make-up day)
- 29. SCHOOL BUS:** Every student is entitled to safe transport to and from school. Any pupil violating that privilege will be in danger of losing riding privileges. Each pupil is assigned a bus route and must be in possession of a bus pass at all times. A driver will not transport a student not assigned to the route unless previous arrangements have been made. Students must be at their assigned pick-up on time. Students will not be picked up or dropped off at any other stop. While on the bus, students will act in an orderly fashion. Students will remain in their seats, will not shout, smoke, or throw items either in the bus or from windows. Any complaints are to be forwarded to the Director of Transportation. Students are to remain on the bus, in the morning, when they arrive at school, until teachers signal for them to enter the building.

First offense: minimum 2 central detentions; Also, see #24 “Misconduct/Disruptive Behavior”

Pupils who continue to be disruptive on the school bus will be suspended from the school bus. Pupils will be required to provide their own transportation. If parent/guardian cannot provide transportation to and from school, this day is not an excused absence.

30. SEXUAL HARASSMENT: Sexual Harassment is any unwanted and/or uninvited verbal or physical behavior of a sexual nature that results in physical harm or causes a person to feel uncomfortable or threatened. Sexual harassment can be, BUT IS NOT LIMITED TO, the following examples. **PHYSICAL EXAMPLES:** forcibly grabbing or kissing someone; touching someone in an inappropriate way; making sexual gestures; licking lips or making suggestive body movements; staring at someone's body. **VERBAL EXAMPLES:** commenting about someone's body; talking about someone's sexual orientation in a way that makes a person uncomfortable. The severity of the disciplinary action will be based upon the circumstances of the infraction. The disciplinary action may range from central detention to out-of-school suspension. In addition, complaints may be signed by the E.H.T.P.D.

31. SMOKING and USE OF TOBACCO PRODUCTS: Smoking and tobacco products (including snuff, snus, and chewing tobacco) are prohibited on all school grounds, buses, buildings, and during any school sponsored function, according to State Law and Policy 5533 Pupils/Smoking. Violators of the law will be subject to the penalties prescribed by the statutes, which include the signing of a misdemeanor complaint with the municipal court.

Sanctions include, but are not limited to, 4 days out-of-school suspension, parent conference, and a formal complaint may be filed with the Department of Health.

Pupils are not permitted to be in possession of cigarettes, tobacco products, matches or lighters while on school property. These items will be confiscated and discarded.

32. THEFT: Pupils illegally possessing school property or the property of others will receive a minimum of one-Saturday Detention and/or up to a ten (10) day out of school suspension. The local authorities may be contacted depending upon the severity of the situation.

33. TRUANCY: Pupils who are unlawfully absent from school (truant) or leave school without permission will be assigned Saturday Detention. In addition, each day a pupil is truant will count as an UNEXCUSED ABSENCE. Four truancies will place a student on no credit status.

34. UNAUTHORIZED or OFF LIMITS AREA: Pupils in an unauthorized or off limits area will be issued a minimum of, but not limited to, one Saturday Detention.

35. UNAUTHORIZED POSSESSION OF SCHOOL FORMS: Students found to be in unauthorized possession of school forms will be issued a minimum of, but not limited to, one Saturday Detention.

36. UNAUTHORIZED SALES: Unauthorized sales of candy, gum or any other goods are strictly prohibited. Sale items will be confiscated and disciplinary action may be taken.

37. UNSERVED CENTRAL DETENTION: Students may be issued a Saturday Detention and suspended out-of-school for subsequent offenses. Students in special programs such as SENIOR EARLY RELEASE, must serve detentions during the activity period.

Exceptions will not be made for employment obligations.

38. UNSERVED SATURDAY DETENTION: Should a student have an unexcused absence from a Saturday Detention, he/she will be assigned one day of out-of-school suspension, plus attend the next scheduled Saturday Detention. A second unexcused absence to an assigned Saturday Detention will result in a two

day out-of-school suspension beginning on the following Monday, plus attend the next Saturday detention, loss of all privileges and a parent conference upon returning from the suspension.

Exceptions will not be made for employment obligations.

- 39. UNSERVED TEACHER DETENTION:** The original detention assignment will be doubled. Continued infractions will result in a minimum of, but not limited to a Saturday Detention.
- 40. USE OF UNACCEPTABLE LANGUAGE AND/OR GESTURES DIRECTED AT STAFF MEMBER:** Pupil will be given a minimum of, but not limited to an immediate out-of-school suspension of four (4) days.
- 41. VANDALISM:** Defacing school property in any way is a serious offense. Any pupil committing such an action will receive a minimum of one Saturday Detention and up to a maximum of a 10-day out of school suspension. Parent will be held financially responsible for damages. Local authorities may also be contacted depending upon the severity of the vandalism.
- 42. VIOLENCE AND/OR THREATS DIRECTED TOWARD A STAFF MEMBER:** This is a very serious offense. Pupil will be immediately suspended from school for ten (10) days and must appear before the Principal. A staff member may choose to sign complaint may be signed with the Egg Harbor Township Police Department.
- 43. VO-TECH SIGN IN:** Vo-Tech students must sign in at the Attendance Office upon arrival from Vo-Tech. Failure to do so will result in three Central Detentions. Students are only permitted to sign themselves in. Students caught signing-in other students will be charged with forgery.
- 44. WEAPONS:** Any pupil in possession of a firearm or other deadly weapon, including look-a-likes, will be arrested, suspended from school for 10 days and be referred directly to the Principal and a police complaint will be filed. This is part of the Weapon Free School Zone Act. Pupils found in possession of a knife not defined as a deadly weapon will be suspended for a minimum of, but not limited to, 4 days in addition to a parent conference.

GUIDANCE SERVICES

Guidance Services exists for young people and plays a vital part in the overall functioning of the school program. Each counselor has a cross-section of students grades 9 - 12 to handle academic, career and personal concerns. The academic program (course selection and scheduling) is the responsibility of the student, parent and counselor. Together, they plan the courses and credits necessary for graduation. All questions concerning a student's academic program and schedule must go through the Guidance Services Department. Special requests for unusual academic programs will ultimately be decided by the Director of Guidance Services and/or the Principal.

The Guidance Services Department is involved in numerous areas including: individual and group counseling, college information and visitations, career counseling, and standardized testing. Parents/guardians who do not wish their child to receive guidance services should submit a written request to the Supervisor of Guidance Services, 24 High School Drive, Egg Harbor Township, NJ 08234.

Students are encouraged to assume personal responsibility and take initiative in utilizing the Guidance Department. It is important that students register for the most rigorous coursework they can handle to realize their full academic potential. Students should anticipate course failures and register for summer school as necessary. Information regarding summer school registration will be included with the distribution of final report cards.

COUNSELOR/STUDENT CONFERENCES

Students who receive a pass to Guidance Services must report at the designated time. Students should report to class if they have a test. The student will then report to Guidance immediately following the test. Students who miss class due to Guidance appointments will be given the opportunity to make up all missed work.

GRADUATION REQUIREMENTS

Credits and Promotion:

1. Grades 9, 10 and 11 are required to earn 120 credits for graduation. Grade 12 is required to earn 115 credits for graduation. The New Jersey Department of Education also requires different coursework for various graduating classes. These requirements are detailed on the following pages.
2. Students are encouraged to carry 35 credits. No student will be permitted to drop below 30 credits without permission from the Supervisor of Guidance and/or Principal. Parents/students should be aware that attempting less than 30 credits will adversely affect athletic eligibility and progress toward graduation. Please see the “Athletic Eligibility” section on pages 45 for more information.
3. Students entering high school will continue on to the next homeroom level along with their entry-level class, until the end of the 11th grade. Prior to entering a senior homeroom, each student must have earned 80 or more credits.
4. All required courses must be passed in proper sequence. The EHTHS Program of Studies lists pre-requisite course for all academic sequences and can be found at www.eht.k12.nj.us.
5. No credits will be awarded or waived through testing. All credits must be earned through coursework.
6. A passing score on both sections (Math and Language Arts) of the HSPA is required for graduation. No student may participate in graduation unless all requirements have been met.
7. Course Level Adjustments/Course Withdraw:
 - (1) Students may make a course level adjustment until October 14. After this time, students will remain in their selected course level for the remainder of the year. If a student drops down a level, the receiving teacher will obtain said student’s grade from the previous teacher and include it in the first marking period average.
 - (2) Changes in course selection after the school year begins are not permitted. Only course level adjustments can be made up until the October 14 deadline.
 - (3) Students may withdraw from a course until October 14. A student making such a withdraw will be placed in study hall. Withdraw from a course should occur only after all academic interventions have been exhausted. After October 14, students must remain in their selected coursework for the remainder of the year. Students will not be permitted to enter study hall after October 14.
 - (4) Study hall capacity will be capped for each period of the day. Once study hall capacity is reached in any given period, students must remain in their selected course for the remainder of the year even if the request was made prior to the October 14 deadline.
 - (5) Students who feel that they are not being appropriately challenged in their current academic level should see their counselor as early in the year as possible but no later than October 14. A request to move from college prep to honors level during the school year requires an appeal to the content area supervisor.

GRADUATION REQUIREMENTS - CLASS OF 2012

ENGLISH I, II, III, IV	20 CREDITS
HEALTH/PHYSICAL EDUCATION	20 CREDITS

MATHEMATICS	15 CREDITS
SCIENCE	15 CREDITS
U.S. HISTORY I & II	10 CREDITS
WORLD CULTURES	05 CREDITS
WORLD LANGUAGE	05 CREDITS
FINE, VISUAL OR PERFORMING ART	05 CREDITS
PRACTICAL ART	05 CREDITS
<u>ELECTIVES</u>	<u>15 CREDITS</u>
TOTAL	115 CREDITS

GRADUATION REQUIREMENTS - CLASSES OF 2013, 2014*, 2015*

ENGLISH I, II, III, IV	20 CREDITS
HEALTH/PHYSICAL EDUCATION	20 CREDITS
MATHEMATICS	15 CREDITS
SCIENCE	15 CREDITS
U.S. HISTORY I & II	10 CREDITS
WORLD CULTURES	05 CREDITS
WORLD LANGUAGE	05 CREDITS
FINE, VISUAL OR PERFORMING ART	05 CREDITS
PRACTICAL ART	05 CREDITS
<u>ELECTIVES</u>	<u>20 CREDITS</u>
TOTAL	120 CREDITS

* The graduating classes for 2014 & 2015 will satisfy a 2.5 credit requirement in financial literacy via a previously completed course in HS 101 or through future coursework currently under development.

GRADING PROCEDURES

Each numerical grade represents the academic achievement of the student in that course. The letter equivalents are as follows:

<u>Grade</u>	<u>Numerical</u>	<u>Description</u>
A	90 - 100	Outstanding Achievement
B	80 - 89	Above-Average Achievement
C	70 - 79	Average Achievement
D	60 - 69	Minimal Achievement
F	Below 60	Unacceptable Achievement

Students with incomplete work for legitimate reasons, e.g. illness, family crisis, will have a grade entered that reflects work submitted to date. The teacher will add a comment code to report cards stating that work is incomplete. The parent, teacher, and student should ensure that the grade is adjusted in a timely manner. Grade adjustments must be entered no later than two (2) days after the last day of school. All grade appeals must be filed with the content area supervisor by June 29, 2012. After this date, grades are official and part of the permanent record.

Any course taken outside of EHTHS must receive prior approval from the Guidance office. NEW CREDIT or REMEDIAL CREDIT will be Pass/Fail only. The grade for new credit/remedial credit will not be calculated into the student's G.P.A.

HOMEWORK POLICY

Research has shown that parental involvement in a child's learning is a key factor in school achievement. To provide your child with the best possible education, homework assignments must be completed to the best of your child's ability. This is an important extension of the school day and will cultivate an appreciation for learning. For more information concerning homework, please refer to Board of Education policy #2330 on the district's website.

INTERIM PROGRESS REPORTS

Interim Progress Reports will be issued to students for each course at the halfway point of each marking period. These reports are an indication of progress, they are not grades. Interim Reports will be sent home via the students to parents/guardians. Interim report dates are the same for all schools and will be posted on the district website at www.eht.k12.nj.us.

REPORT CARDS

Report cards indicate grades, the number of absences, and teacher comments for each course. Report cards will be issued to students for the first three marking periods. Fourth marking period report cards, including final grades, will be mailed home. Report card dates are the same for all schools and will be posted on the district website at www.eht.k12.nj.us.

PARENT PORTAL

While hardcopies of progress reports and report cards will continue to be sent home throughout the year, the best way to monitor student progress is through the use of Infinite Campus' Parent Portal. Parents can track student performance with real-time data in each individual course. This access should enable families to positively reinforce student's academic efforts as well as intervene in any problem areas before official grade reports are issued.

If you do not currently have access to the parent portal, you are encouraged to register by calling the Guidance office at 653-0100. A member of the Guidance staff will be happy to assist you in getting a logon and password as well as an explanation of how to get started. The few minutes invested will pay great dividends in your child's academic success.

CLASS RANK/GPA

1. Official class rank is determined by numerical grade point average. Official class rank/GPA is calculated once a year in the summer after all final course grades have become official. Students are ranked within their own grade level only.
2. Grade point average is computed as follows:

$$\text{G.P.A} = \frac{\text{Total Quality Points}}{\text{Total Credits Attempted}}$$

3. Quality points for each course are determined by multiplying the numerical value (including grade weight, if any) of the final grade for the course by the total number of credits assigned to the course.

4. Advanced Placement courses will receive a 20% weighting to the final grade. To receive AP course weighting, a student is obligated to take the AP Exam. Failure to take an AP Exam will result in the removal of weighting for the corresponding final course grade. AP students and parents will sign a contract detailing this provision before leaving for summer break.
5. Courses specific to the Medical Science Academy (MSA) will receive a 20% weighting to final grade.
6. Honors courses will receive a 10% weighting to the final grade.
7. No grade higher than 100 will be given at any time on report cards or for final grades. The computer system will automatically include A.P. and Honor weightings into those courses when calculating GPA and Class Rank. If a student needs a 4.0 GPA for college application/scholarship purposes, it will be computed as follows (***class rank, however, is still determined by the official numerical GPA***):

<u>Advanced Placement/Honors</u>	<u>College Prep/Standard</u>
A = 5	A = 4
B = 4	B = 3
C = 3	C = 2
D = 2	D = 1
F = 0	F = 0

8. Independent Study: Grades for independent studies are Pass/Fail. Students will be awarded 5.0 credits for a full-year independent study which will be documented on their transcript. The topic must be an original course of study not found in the EHTHS Program of Studies. The study's title and content is developed by the student and cooperating teacher. Further information is available in the independent study application packet available in the Guidance office.
9. Any student dropping levels during the academic year from a weighted course (i.e. Honors) to a non-weighted course (i.e. College Prep) carries his/her non-weighted average to the next class. Course weightings are only applied to final grades and, therefore, do not follow students to non-weighted courses.
10. Alpha transfer grades will be converted to numerical mid-range grades using the EHTHS Alpha to numerical reference grades as a guide. Failures will be recorded as a 55 unless sending districts can provide numerical grades.
11. Transfer-In Students: If your transcript designates a course as Honors, we will accept it, as long as we offer a corresponding Honors course and we can certify that your course covered the EHTHS curriculum.
12. To be considered for Valedictorian and Salutatorian, students who transfer into EHTHS must have attended EHTHS for a minimum of 3 semesters by the end of his/her first semester of their senior year. Alpha transfer grades will be converted to our mid-range numerical grades unless sending districts can provide numerical final grades.

HONOR ROLL

1. Honor Roll - Numerical average of 80 (non-weighted) or better in all subjects with no grade being less than an 80.
2. High Honor Roll - Numerical average of 90 (non-weighted) or better in all subjects with no grade being less than a 90.

QUARTERLY ASSESSMENTS

1. The value of the quarterly assessment will be 10% of the marking period grade. Teachers will incorporate this grade into a student's marking period average in the class.
2. Instructions on content are assessment procedures will be issued prior to quarterly assessment administration.
3. Prior to the start of fourth marking period quarterly assessments, students who have at least a 90 average for the year will be exempt from the final quarterly.

PUPIL RECORDS POLICY/FERPA NOTIFICATION

A central file is maintained on each student in the Guidance Office. Additional information might be maintained in several other areas of the school. Records containing information relevant to your education are available to your parents or to yourself if you are 18 years old.

A member of the school staff responsible for the maintenance of the records will be present to provide interpretation of the records should you or your parents choose to review them. Therefore, an appointment must be made in advance to ensure adequate staffing. For security purposes, photo identification is required at the time of records examination. A parent, or pupil at least eighteen years of age, may question records, in writing, on grounds of inaccuracy, irrelevance, impermissible disclosure, inclusion of improper information, or denial of access.

Federal law protects the privacy of student educational records for parents and students who have reached the age of 18 years. Egg Harbor Township Schools comply with the Family Educational Rights and Privacy Act (FERPA), which addresses rights to privacy and access to student educational records.

PROTECTION OF PUPILS RIGHTS (PPRA)

The *Protection of Pupil Rights Amendment* (PPRA) requires written consent from parents/legal guardians and pupils who are 18 years old or emancipated minor pupils before minor students are required to participate in a survey, analysis, or evaluation funded in whole or in part by a program of the United States Department of Education that concerns one or more "protected information surveys". This consent requirement also applies to the collection, disclosure or use of pupil information for marketing purposes, referred to as "marketing surveys", and for certain physical examinations and screenings. Parents and eligible pupils will be provided an opportunity to opt a pupil out of participating in such surveys and screenings. Parents and eligible pupils, upon request and before administration or use, also have the right to inspect such surveys, instruments, and instructional material used as part of the educational curriculum. Parents or students who believe their rights under PPRA may have been violated may file a complaint with United States Department of Education.

TESTING PROGRAM

The following are some of the tests that are available to students. Further information and testing dates may be obtained from the Guidance Office.

1. Grade 9 – 12: Students taking Biology for the first time will take the NJ Biology Competency Test (BCT).
2. Grade 9 – 12: Students taking Algebra I for the first time will take the NJ End-of-Course (EOC) Algebra I Assessment.
3. Grade 11 students will take the HSPA until both sections have been passed.
4. Grades 9-11: Preliminary Scholastic Aptitude Test (PSAT).
5. Grades 11-12: College entrance exams, (SAT) and/or (ACT).
6. Grade 12: Alternative High School Assessment (AHSA); Students not proficient in one or both sections of the HSPA must participate in the AHSA as an alternative means of demonstrating proficiency.

PLANNING POST-SECONDARY EDUCATION

Intelligent, careful and continuous planning is vitally important for students who desire to attend college or seek to further their education after high school. From their freshman year, students should make a habit of visiting the college/career center in the Guidance Office. By the time a student is planning subjects for his junior year, he/she should have some idea about the type of college or school he or she wishes to attend. Completed college applications must be submitted ten (10) school days before their due date to ensure complete processing. Applications arriving after this time are not guaranteed and are treated on a time available basis.

Many post-secondary school representatives visit the high school during the school year. Students should plan to meet with these representatives to gain practical knowledge of the institution. If seating is limited for a particular visitation, juniors and seniors will be given priority.

Students planning to continue their education should plan to consult with their counselor at their own convenience concerning information in the following areas:

1. Requirements for college.
2. Information about schools.
3. Selection of colleges and schools.
4. Completing applications.
5. Campus visitations (must be pre-arranged with counselor).
6. NCAA Athletic Eligibility.
7. PSAT, SAT and ACT assessments.
8. Tuition Costs/Financial Aid/Scholarships.

ARE YOU TAKING THE MOST CHALLENGING COURSES YOU CAN?

Most four-year colleges require a minimum of H.S. Algebra I, Algebra II and Geometry for acceptance. Most four-year colleges require a minimum of 16 academic College Prep units or higher in the areas of: English, Math, Lab Science, Social Studies, and Foreign Language. Students seeking admission to highly selective colleges should take significantly more than 16 academic units. Art, Business, Music, Vocational and Industrial Arts and Technology courses are not considered academic units by most four-year colleges.

Four-year colleges that do not require the coursework mentioned above tend to be small, private schools. These schools may not be geographically convenient or financially feasible for all students. Also, they may not carry regional academic accreditation, which affects the value of a college degree. Contact your counselor for more details.

New Jersey community colleges require the *Accuplacer* test. A minimum level of proficiency is required in Algebra, Language Arts and Writing. Low proficiency scores on this test will result in placement into remedial courses to bring a student up to entrance level proficiency. This translates into more time in college and additional financial costs. Therefore, rigorous high school coursework is also beneficial to the two-year college bound student.

Many technical, business and nursing post-secondary programs also require basic algebra and solid reading and writing skills as part of their entrance requirements.

The Guidance department urges you to take the most rigorous courses as possible while in high school. We want you to be prepared to enter the career or post-secondary school of your choice when you graduate.

RECRUITER ACCESS TO STUDENTS

The term "recruiter" shall refer to any recruitment representative of a four-year college, two-year college, vocational school, branches of the U.S. Armed Services, and employers.

EHTHS recognizes the needs of college, vocational, occupational, and military recruiters to disseminate information to students. Consequently, recruiters of all types will be given equal and reasonable access to

students.

Recruiters will be allowed to visit the high school to disseminate information to students one (1) time each marking period but not to exceed four (4) times per year for any one organization or military branch. The guidance office will facilitate student registration and advertise the event in advance so that recruiters can meet with groups of students in the Career Center or, if they so choose, a display in the cafeteria/commons area. Regardless of choice, each visit will constitute one of the four visits allowable per year. Individual meetings involving recruitment should take place at the recruiter's office or student's home. At no time will students be removed from class for an unscheduled individual visit with a recruiter.

Recruiter's request for directory information as outlined in this handbook will be honored (as per section 9528 of the ESEA and P.L. 107-110) with a minimum of 48 hours notice and should be requested by phone. Requests for information on individual students should be made in advance as well. At no time will recruiters be allowed to solicit students who have not expressed an interest in their organization.

NCAA ATHLETICS

Students who plan to pursue NCAA athletics should declare their intent in writing to their coach and counselor as specific coursework is required for NCAA eligibility. It is the responsibility of the student to declare interest so that he/she can be advised properly. The importance of this notification cannot be overstated as it is impossible to advise a student retroactively in the NCAA process. The counselor and coach will document when the student first notified the high school of his/her interest.

CAREER SERVICES

A Career Speaker series is presented to students by local men and women actively and successfully engaged in various careers. Students can register for these workshops in the Guidance office and are responsible for the any work missed in class.

The COIN Career Guidance System assists students with career searches, college searches, military information, and vocational school information. COIN is also an effective tool for writing resumes and cover letters. Make an appointment with your counselor for more information.

WITHDRAW FROM SCHOOL

A student desiring to withdraw from school must first consult the appropriate counselor when making his/her decision. He or she should not remain absent for any prolonged period of time. In addition, these steps should be followed without exception.

1. To obtain a withdrawal form and start the process, a student must first meet with a counselor.
2. Students under the age of 18 years old must be accompanied by a parent/guardian at time of withdrawal.
3. A withdrawal slip will then be issued.
4. Return all books, uniforms, and other school property to teachers/coaches who will initial the slip.
5. Return the completed and properly initialed withdrawal slip to the Guidance Office.
6. Transcript or transfer cards may not be released until all obligations have been met.

WORKING PAPERS AND AGE CERTIFICATE

New Jersey State Law requires every person under the age of eighteen who is employed full or part-time to obtain working papers. A birth certificate, baptismal certificate, or passport, is required for proof of age. The necessary forms may be obtained from, and must be returned to, the Guidance Office. As per state law, the child must be present while working papers are being processed. These forms are also available on the school's website. When school is in session, students must obtain necessary forms during the school day. When school is not in session, working papers may be obtained every weekday between 9:00 a.m. and 12:00 p.m. ONLY.

NEW STUDENT ENROLLMENT

RESIDENCY/GUARDIANSHIP/VERIFICATION PROCEDURES AND AFFIDAVITS

NJSA 18A: 38-1 requires a student and parent/guardian to be domiciled within a school district for the student to receive a free public education. As per NJSA 18:38A, the Egg Harbor Township School District specifically expects parents/guardians to provide notarized affidavits and documentation confirming proof of residency and guardianship. These affidavits will be recorded in the student's record file. Parents/guardians may be required to furnish to the school board, upon request, their state and federal income tax records as further proof of verifying guardianship and residency. Please call central registration at 653-0100, extension 1234 for additional information.

SUMMER SCHOOL - CREDIT COMPLETION ENROLLMENT POLICY

Students will make every attempt to successfully complete their courses of study during the regular school year. Students who do not successfully complete their course work will attend summer school to receive credits. Following are provisions for summer school attendance:

1. Students who do not successfully complete courses are advised to retake the course in summer school. It is highly recommended that the student retake the course in the summer immediately following the school year.
2. Graduation requirements may be taken during the course of the following academic year, space permitting. Students scheduling a class for the first time will be given priority over students seeking to repeat a course.
3. Any course remediated in summer school will be awarded credit upon its successful completion. The summer school grade is considered pass/fail and does not replace the course grade earned at EHT.
4. Students must earn 80 credits to be placed in a senior homeroom. Final evaluation will be conducted by the Guidance Department following summer school.
5. Students must fulfill credit completion obligations in the summer immediately following the academic year in which they have exceeded the number of unexcused days or illegal absences. Days will not be carried over to the following summers. Students who do not complete their credit completion obligations will repeat the academic year.
6. Students on no-credit status must attend credit completion at an approved program. Any costs incurred will be the responsibility of the student.

STUDENT ASSISTANCE PROGRAM

1. The Student Assistance Coordinator (SAC)

The SAC is available to offer information about resources in the community including support groups, individual & family counseling, behavioral health programs, rehabilitation programs, and aftercare services. Student communication with the SAC regarding substance use issues remains confidential under CFR-42 of the federal code.

2. Intervention and Referral Services (I&RS)

I&RS is a coordinated system for the planning and delivery of intervention and referral services. This system is designed to assist students who are experiencing **learning**, **behavior**, or **health** difficulties and

to assist staff who have difficulties in addressing students' learning, behavior, or health needs. It accepts referrals from teachers, administrators, support personnel and parents. All referrals are considered confidential, and federal regulations are strictly followed.

EAGLE ACADEMY

Eagle Academy is an alternative educational facility for at-risk students in grade 7-12 who are failing to meet success in the traditional classroom setting.

Criteria for Admission:

Age

Credit status

Inability to attend traditional high school due to extenuating circumstances:

chronic illness

substance abuse

other health impairments (physical or emotional)

transitional placement

Criteria For Attendance:

The student will abide by the attendance policy as defined in a mutually constructed contract and in conjunction with the EHTHS Board of Education approved attendance policy.

Criteria for participation in EHTHS activities, events and athletics will be determined on a case-by-case basis.

Criteria for Readmission to EHTHS:

In an effort to promote the ***successful return*** to the regular high school program from the EHT Alternative School (Eagle Academy), ***all students and their parents/guardians must participate in an EXIT CONFERENCE***.

This exit conference will be conducted by members of the I R & S Team and when appropriate, Youth Study Team. The exit conference will be scheduled by the high school principal ***after*** he is notified by the Director's intention to return the alternative school student to the regular school program.

The components of the exit conference will include, but not limited to the following provisions:

- One semester of passing grades, good attendance and minimal disciplinary history.
- A urine drug screening paid for by the Board of Education and a signed contract for further periodic urine screenings for one full calendar year. A positive finding will result in referral to an appropriate treatment program at parent's expense. The student will be re-tested in 30 days. A positive finding will result in a reevaluation of placement.
- Participation in a Teacher Mentor Program.
- Appropriate recommendation to community services may be made by the I&RS Team to insure the Teacher Mentor Program.

Refusal by student or parents/guardian to comply with the above outlined requirement for return will result in the student ***remaining*** in the Alternative School.

GENERAL ATTENDANCE RULES AND REGULATIONS

Compulsory attendance at school is a longstanding state policy and has been upheld by the court of New Jersey and the U.S. Supreme Court as a matter of public concern and legislative regulations. Consequently, there is an impelling responsibility upon the parents and student for the student to attend school as scheduled. Therefore, the Egg Harbor Township High School cannot condone or permit absences from school for minor reasons and will not issue credit if minimum pupil attendance requirements are not met.

ATTENDANCE

Pupils are required to attend school regularly in accordance with the laws of the state. A pupil will be considered to have attended school if he/she has been present at least four and a half (4.5) hours during the school day.

A pupil not present in school because of his/her participation in an approved school activity will be considered to be in attendance.

An Excused absence is an absence for one or more of the following reasons:

1. The pupil's illness (One to two days requires a Parent/Guardian Note the following day. Three or more days requires a note from a physician)
2. Family illness or death
3. Educational opportunities
4. Excused religious observances
5. The pupils suspension from school
6. The pupil's required attendance in court
7. Interviews with a prospective employer or with an admissions officer
8. Examination for a driver's license
9. Necessary and unavoidable medical or dental appointments

It is our understanding that the reasons listed above do occur during the year. However, these absences must be kept at a minimum.

An Unexcused absence is a pupil's absence for any reason other than those listed above.

Family vacations are also unexcused absences.

Truancy is a pupil's absence from all or part of the school day without the knowledge of the pupil's parent/guardian. A pupil who leaves school without permission when school is still in session will also be considered truant. Students found truant will be issued AEP, and the absence is unexcused.

STUDENT/PARENT RESPONSIBILITIES

Students shall attend school daily unless the absence is excused.

Parents shall insure that their child attends school punctually and daily and be aware of all absences.

NOTICE TO SCHOOL OF A PUPIL'S ABSENCE

Parents shall call the school the morning of the pupil's absence.

READMISSION TO SCHOOL AFTER AN ABSENCE

When the student returns to school, he/she shall present a verified note to the Attendance Office, dated and signed by the parent/guardian, with a written statement of the reasons for the absence. Parent notes will only be accepted if turned in immediately upon a pupil's return.

DOCTORS' NOTES

Doctors' notes will only be accepted for specific days of absences. No "blanket coverage" notes will be

accepted. The school physician may be asked to review any questionable medical situations.

Doctors' notes must be given directly to the Nurse. Altered notes will not be accepted. When verifying notes with a doctor's office, if it is discovered that the note has been forged or stolen, the day will become an unexcused absence. No subsequent notes will alter that unexcused status. Students will be referred to their Assistant Principal.

DENTAL APPOINTMENTS

Dental/orthodontic appointments should be scheduled during after school hours whenever possible. When unable to do so, the student is expected to come to school, sign out for the appointment and then return to school, or sign in late with an excuse from the dentist. Full days will not be excused for dental reasons unless specified by the dentist's note.

COLLEGE VISITATIONS

Students who intend to visit a college must notify their counselor of their plans in advance. Students must report to a college admissions office and receive certification that they have met with an admissions director or counselor or received a tour sanctioned by the college.

FAMILY VACATIONS

Family vacations are not excused absences. Families are encouraged to schedule their vacations to coincide with school holidays. This will eliminate the need for students to miss valuable class time. Students will not be given additional excused absences for family vacation. Students must be sure that their absences do not jeopardize their credit standing.

ABSENCES AND INSTRUCTION

The parent/guardian of pupils who anticipate an excused absence of three (3) or more school days should contact the Main Office to request such home assignments.

Homebound Instruction – A pupil who anticipates an excused absence due to a temporary or chronic health condition may be eligible for home instruction. The parent/guardian must request home instruction in writing to the Director of Home Instruction. This request will be accompanied by a signed physician's notice stating the illness/diagnosis and the anticipated length of absence, including a specific beginning and ending date. The request for home instruction must be approved by the school physician. Homebound instruction will be considered an excused absence.

Make-up Work – Pupils absent for any reason are expected to make up the work missed. The pupil is responsible for requesting missed assignments and any necessary assistance required. Pupils choosing to cut classes or be truant will not be permitted to make up work missed during those time periods. Pupils may complete assignments for time missed because of action initiated by the administration, i.e. suspension.

ABSENCES AND PARTICIPATION IN SCHOOL EVENTS

If a student is absent from school the day of an athletic event, club meeting, or performance, the student cannot participate in that event unless the absence has been cleared in advance by the Assistant Principal.

A student must be in school in order to attend a practice or activity that day by 9:29am in order to attend a practice or activity that day.

Students who are on NO CREDIT STATUS will be prohibited from participating in athletics and activities. In addition, these students will be prohibited from attending trips that are not class related. This means that band

trips, class trips, and the like, that cause students to be absent from school, will be off-limits to students on NO CREDIT STATUS.

LOSS OF COURSE CREDIT

Pupils who accumulate more than **fourteen (14)** unexcused absences will not have completed the prescribed course of study and, as such, will not qualify to receive the assigned credit for the course. As a result, they will be placed on NO CREDIT STATUS. **Please note: credit status will not be jeopardized for a pupil who is absent fourteen (14) days or less.**

If a student is in danger of losing credit, parents/guardians will be notified. Parents will receive a warning letter upon absence number nine (9) and a NO CREDIT STATUS letter at the time of the fifteenth (15) absence. Students, however, are ultimately responsible for days absent from school. Attendance print outs will only be given to students who believe they are on NO CREDIT STATUS and will only be available during their lunch periods.

A pupil denied course credit may attend a credit completion session to regain the denied credit, provided the pupil has not been absent more than thirty 30 times unexcused, 35 total.

CREDIT: IF A STUDENT ACCUMULATES MORE THAN 20 UNEXCUSED ABSENCES, OR IS ABSENT A TOTAL OF 35 DAYS OR MORE AND IS NOT ON HOMEBOUND INSTRUCTION, THAT STUDENT WILL NOT RECEIVE CREDIT AND MUST REPEAT THE YEAR.

APPEALS

A pupil who has been denied course credit for excessive absences may appeal that action in accordance with the following procedures:

1. The pupil shall file a written appeal to the Assistant Principal within five **(5)** school days of receiving notice of the action. If the pupil is not satisfied, he/she may submit a written request to the Principal for consideration by an Attendance Review Committee.
2. The Attendance Review Committee shall decide the appeal and inform the pupil in writing within seven **(7)** working days of the meeting.
3. The pupil may appeal an adverse decision of the Attendance Review Committee to the Superintendent within seven **(7)** calendar days of the Attendance Review Committee's decision.
4. If the Pupil does not agree with the Superintendent, an appeal can be made within ten **(10)** calendar days to the Board of Education.

NO CREDIT STATUS AND CREDIT COMPLETION

Credit Completion

Any pupil on NO CREDIT STATUS can regain credit by attending a Credit Completion program.

- A pupil will attend one session of Credit Completion for each unexcused day over the fourteen (14) day limit. For instance, if a student is absent seventeen (17) days and none of those days are excused, he/she must attend Credit Completion for three (3) sessions.
- If a pupil does not attend Credit Completion for the designated length of time, the student will not receive credit and must repeat the entire year.

- **Students may only utilize credit completion once during the 1st three Marking Periods and once during the 4th Marking Period.**
- The I&RS team will continue to collect appeals during the beginning of the forth marking period for students who still may be on NCS.

Senior-Only Credit Completion Option

A senior who is on No Credit status may not participate in their graduation ceremony unless they attend the Senior-Only Credit Completion Option. This option allows seniors to fulfill their attendance obligations prior to graduation. Seniors on No Credit Status who successfully complete the Senior-Only Credit Completion Option would be permitted to participate in graduation.

The chart below indicates the number of weeks required for Summer Credit Completion and the equivalent days required by the Senior-Only Credit Completion option. The dates of the Saturdays and Graduation practice days will be established by the EHTHS administration after the credit appeal process.

Summer Weeks to be Served	Senior-Only Option
1 – 2 weeks	1 Saturday (8:00 AM to Noon) & 2 days during the senior graduation practice (Mon-Fri) TBA by EHTHS Administration. (8:00 AM to 12:10 PM = Total 12 Hours and 20 minutes)
3 or more weeks	2 Saturdays (8:00 AM to Noon) & 3 days during the senior graduation practice (Mon-Fri). (8:00 AM to 12:10PM - Total 20 Hours and 40 minutes)

ABSENCES - MISCELLANEOUS

Consecutive Absences - Any pupil who misses ten (10) consecutive school days, and who is not on Home Instruction, and/or who is not medically verified as incapacitated, will be issued a written notification to report to school within five (5) school days. Failure to do so will result in the following:

1. Pupils under the compulsory school age (below 16) shall have presented to their parents, a formal written notice to cause the child to attend school. Failure to comply will result in court action.
2. Pupils above 16, who do not comply with the return to school notice, will be given ten (10) days to notify the Principal as to why they have been absent. If the student refuses to do so, the student will be dropped from the rolls of the school and must petition the High School Principal, in writing, for re-admittance.

LATENESS POLICY

It is important that students arrive to school on time. Students who are tardy must sign in at the attendance office and obtain a pass to class. Students must also sign in before the end of homeroom to receive credit for the day. Tardy students will be subject to the following disciplinary action:

- 1st to 3rd tardies to school = Warning
- 4th to 11th tardies to school = Minimum of, but not limited Central Detention from the Assistant Principal's office.
- 12 or more tardies to school = A minimum of, but not limited to one Saturday detention, and a parent conference with an administrator may be required.

EARLY RELEASE

Requests to sign out early will be granted for confirmed medical and dental appointments, as well as for driver's tests, etc. In case of illness, a student must report to the Nurse's Office and may be sent home by the nurse after a parent is contacted. Students may not sign themselves out of school. If a student is being signed out, the following procedure will be followed:

1. The parent/guardian responsible will report to the Front Desk and ask for the student. **Students will not be released to anyone except the legal parent or guardian unless prior arrangements have been made with the appropriate Assistant Principal in advance.**
2. The student will report to the Front Desk and officially sign out. Students who do not officially sign out will be marked as truant.
3. Students are responsible for all missed work.
4. Students must be present 4.5 hours to receive credit for the day.

SIGNING IN LATE & SIGNING OUT EARLY (NO CREDIT STATUS)

Signing in late and signing out early for any reason not excused will result in an unexcused absence from the class or classes missed that day. These unexcused absences will count toward the fourteen (14) unexcused absences allowed. If students accumulate more than fourteen (14) unexcused absences in a certain class or classes as a result of being absent from school and signing in late or signing out early, they will be placed on NO CREDIT STATUS and will not be able to participate in school activities. They will also have to attend Credit Completion in order to receive credit for these classes.

GENERAL INFORMATION

ACADEMIC HONESTY POLICY

Students are expected to demonstrate honesty and integrity while in attendance at Egg Harbor Township High School. Each student is expected to do his/her own work. All work submitted by a student should be a true reflection of his/her own effort and ability. Any deviation from this standard is considered unacceptable academic behavior.

Cheating is ***unacceptable academic behavior***. Cheating is representing someone else's work as one's own. Any form of cheating, to any extent, is wrong. This improper conduct is a disservice to one's own educational program, as well as to that of others.

Whether you give or receive information during an examination or on certain assignments, the offense is the same, and you will receive a zero (0) for the work. Parents will also be notified.

The classroom teacher is the arbiter as to whether or not cheating has occurred. Incidents of plagiarism must be judged by the teacher, as always, in light of what the teacher has taught and what the teacher expects the student to know. The teacher will report all instances of cheating that involves formal and/or major assignments to the appropriate school counselor(s). The ***minimum*** penalty for cheating is a "zero" for the submitted work, and this applies to any student involved. AP/Honors students may be dropped from the Honors program if a second incident occurs.

ACADEMIC VARSITY LETTERS AWARDS

Varsity Letter for Scholarship

Any student who has earned an unweighted GPA of 90 or better for the current year will be considered for an Academic Varsity Letter Award. The GPA will be calculated at the conclusion of the third marking period. GPA for Varsity Scholar purposes is determined by averaging the unweighted term GPA from the first three marking periods. Students maintaining an unweighted GPA of 90 or better for the year will be notified by letter from the principal, and these students shall be considered "Varsity Scholars."

Varsity Scholars will be given award certificates to recognize their success.

BOOK BAGS, BACKPACKS, AND PURSES

Book bags, backpacks, and purses are subject to administrative inspection in the interests of school safety, discipline, and the enforcement of school regulations.

CAFETERIA GUIDELINES

Students are to arrive on time for lunch and will remain in the cafeteria or commons area for the entire lunch period unless excused by a supervisory teacher. Students are to dispose of trash in designated areas. All food purchased in the cafeteria is to be eaten in the cafeteria. Misbehavior in the cafeteria will result in students being assigned the corresponding discipline (see page 11; # 3 Cafeteria/Commons Area). Additional problems will result in students losing cafeteria privileges for the year. There are to be no hats, electronic devices, headsets, games/gambling, card playing, or dice in the cafeteria. Regular school rules are still in effect during lunch.

CARD PLAYING & DICE ROLLING

There is to be no card playing and/or dice rolling in school at any time. Students are not permitted to have cards and/or dice in school. If students are found with cards and/or dice, these items will be confiscated and discarded. Refusal to comply may result in disciplinary action.

CLASSROOM TELEPHONES

The classroom telephones activate the intercom system between the classroom and the offices of the Principal and Assistant Principals. These telephones are for staff use only and are reserved for emergency use. They are a vital part of the school wide communications system and are to be considered your teacher's private property. Students are not permitted to use the telephone. Students who violate this rule will be referred to the Assistant Principal for disciplinary action.

DRESS CODE

The administration of Egg Harbor Township High School believes that personal appearance begins with cleanliness, tasteful dress, and common sense. Appropriate dress is instrumental in creating a feeling of pride among the students of Egg Harbor Township resulting in better behavior, greater school spirit, and higher academic achievement.

Students are expected to look neat and clean at all times for school and for school-sponsored activities, such as concerts, plays, talent shows, dances, etc. The dress code also remains in effect for students attending a school-sponsored trip, unless the trip's sponsor has requested and received specific modifications from the administration due to the nature of the outing.

Any form of attire or style of grooming that is immodest or sloppy, or which adversely affects classroom atmosphere, or which creates a behavioral problem, will be considered unacceptable. Students are welcome to express their individuality and/or ethnic pride through clothing, provided that it meets the following guidelines developed by faculty and administration. All clothing must be clean, neat, and modest.

Students will NOT wear:

1. Clothing which leaves the midriff, back, and/or shoulders exposed. Student shoulders must be covered. The bottom of the upper garment should touch the top of the lower garment.
2. Any form-fitting, tight clothing or ripped jeans.
3. Tank tops or sleeveless shirts.
4. Cut-off sleeveless T-shirts.
5. Pajama tops and/or bottoms, sleep-bottoms, and/or slippers.
6. Hats, hoods, sweatbands, bandanas or headdresses, and/or sunglasses on top of the head or on the face. Students are not permitted to carry these items either. If seen, these items may be confiscated and held for thirty days by the administration.
7. Similarly colored beads.
8. Coats or jackets of any length. Windbreakers are permitted.
9. Undergarments worn as outer garments.
10. Short shorts and skirts. Appropriate shorts and skirts are at least fingertip length when arms are straight down at pupil's side. Other shorts that may not be worn include cut-offs, frayed shorts, spandex, athletic or running shorts, and swimming trunks.

11. Spiked jewelry, wallet chains or other accessories deemed dangerous to others by the administration.
12. Garments with graphics that suggest obscene or offensive material, which detracts from the educational process, and is therefore inappropriate. Examples include but are not limited to:
 - A. Drawings and/or slogans that promote the use of drugs, alcohol, and/or tobacco.
 - B. Profanity and/or sexual references.
 - C. Drawings and/or slogans advocating violence.
 - D. Crude drawings and/or phrases.
 - E. Double meanings.
13. Undergarments should be fully covered by student's pants, skirts, and/or dress.

Students who violate the dress code will be referred to the appropriate administrator for appropriate action. This includes the student changing his/her dress or being sent home from school. Additionally, students violating the dress code will be given disciplinary action (see "dress code" on page 12 of this handbook). If you have any doubt as to whether or not a specific article of clothing may be a violation of the dress code, do not wear it until you are certain it is acceptable. Not all circumstances are necessarily covered by this dress code. Teachers who question the appropriateness of students' attire should send students to an administrator for clarification. ***Students who repeatedly violate the dress code will receive progressive discipline.***

ELEVATORS USE

The elevator is to be used only by individuals who have received special permission from the nurse and school administrators.

EMERGENCY CLOSING

In the event of inclement weather or some other urgent reason that would necessitate the closing of school, students and parents should log onto our school website or tune to channel 2 EHT-TV for the official announcement. ***Please do not call the school or the Egg Harbor Township Police Department.***

EMERGENCY DRILLS

Lockdown- This drill will be implemented as a practice exercise for 911 emergencies warranting students and staff to remain inside the building until further notice.

Evacuation- This drill will be utilized to practice for 911 emergencies (non-fire) warranting students and staff to leave the building.

FIRE ALARMS

According to New Jersey Statutes (18A:41-1 to 5) all schools of two or more rooms shall have at least one fire alarm each month within the school hours. Furthermore, the school will practice one emergency alarm per month. Following are guidelines for fire alarms.

All students are required to leave the building anytime the fire alarm is sounded. Students are to assume that every alarm indicates swift and quiet evacuation.

When the alarm sounds:

1. Cease all activity and talking and remain quiet throughout the entire drill.

2. Follow the instructions of the teacher in charge of your section or class. Stay with your class at all times.
3. Turn off the lights and close all windows and doors.
4. Form a double line and leave the classroom in silence.
5. Leave the building and walk to the area that is designated as the specified distance from the building, 300 feet.
6. Upon reentering the building report directly to the classroom from which you were dismissed or follow other direction given on the public address.

HEALTH SERVICES

General Rules:

1. Students will be admitted to the nurse's office only if they have a pass from a classroom teacher or if summoned by the health office.
2. Students will sign in when reporting to the nurse's office. Students must also sign out. The nurse will give them a pass to class.
3. Students who are required to take over-the-counter or prescription medication during the school day must bring the medication in the original container along with a written doctor's order and a parent's note requesting that the medication be administered. The medication will be taken to the school nurse by the parent upon arriving for the school day. The medication must be taken under the supervision of the nurse. Medication notes must be updated annually.
4. Students who violate the use of the health office will be disciplined accordingly.

Illness: Students who become ill during the school day may request a pass to the health office from their teacher. The nurse will determine the extent of the illness and decide if a student will be dismissed from school. No student is permitted to leave the school campus unless such dismissal is approved by the nurse and cleared through the office. Students will be released to their parent/guardian.

Accident: Any accident must be reported immediately to the teacher or staff member in charge of the classroom, sport or activity. When the student reports to the health office, an accident report will be sent to the staff member supervising the activity. This completed form will be returned to the health office within 24 hours.

Immunization: The State of New Jersey requires the following immunization rules for children entering or attending grades 9-12.

1. Four doses of Diphtheria, Pertussis, and Tetanus vaccine.
2. A minimum of three doses of Polio-myelitis.
3. Two doses of Measles, Mumps, and Rubella vaccine must have been given on or after the first birthday.
4. Hepatitis B series. Students who have not completed the Hepatitis B vaccine series are eligible to attend school on provisional status following receipt of the first dose. A second dose shall be received no later than three months after receiving the first dose and the third dose shall be received no later than 12 months following the first dose.

Laboratory evidence of Hepatitis B, Measles, Mumps, or Rubella immunity will exclude a pupil from the immunization requirements. Students without complete immunization records will be excluded from school.

Student Insurance: Accident insurance coverage is provided by the school district for every student during school time and school sponsored, and supervised activities/sports. This coverage is on an EXCESS BASIS only. This means that only those medical expenses which are not covered by the family's/student's own personal or group insurance are eligible for coverage under this policy up to the limits therein. Forms are available from the nurse's office for those who wish to purchase additional 24-hour accident insurance coverage.

Tuberculin Test: All students transferring in from a school system in certain countries must be Mantoux Tuberculin skin tested.

Physical Examination: Students may have a physical examination completed by their family doctor. Sport physicals need to be recorded on forms provided by the school nurse or athletic office. Sport physicals are valid for the current school year only. Physicals for working papers are valid for 2 years. Any injuries during that time will require medical clearance.

HOMEROOM

Homeroom period will follow third block. This period is established to maintain an organized method of keeping records and to provide important information via EHT-TV.

LAVATORY USE

Lavatories are located throughout the school for your convenience. Students should not congregate, smoke, or socialize in these areas.

LIBRARY/MEDIA CENTER

1. During the school day, a student must have a legitimate pass from a classroom teacher for a specific purpose in order to visit the media center. Guest teachers, study hall teachers, and cafeteria teachers are not to issue passes to the media center.
2. Once a student enters the media center, they must stay for the entire period.
3. All backpacks must be placed at the front entrance of the media center.
4. All students must sign in and give pass to the aide.
5. All students must wear an Identification Badge.
6. No food, gum, or beverages are permitted.
7. Media center privileges will be revoked for 30 days for disrespect, misconduct and/or defiance.

LOCKERS: Hall and Gym

School lockers remain the property of the school district even when used by pupils. Lockers are subject to administrative inspection in the interests of school safety, sanitation, discipline, and enforcement of school regulations. ***Lockers are also subject to search by law enforcement officials.***

Students are assigned individual hall locker for THEIR USE ONLY. Students are not allowed to share lockers. Students found sharing lockers may be disciplined for failing to follow procedures. It is recommended that students do not share their combinations. Releasing combinations to others may result in the unauthorized use of a locker and theft.

Coats, jackets, and gym bags will be kept in lockers at all times. Coats and jackets are NOT to be worn or carried in halls or classes.

The school cannot assume responsibility for theft or loss of belongings from lockers. Furthermore, it is recommended that students not leave their P.E. attire in their gym lockers after class or overnight. P.E. lockers can only be used during P.E. classes. ***P.E. lockers REQUIRE students to use their own combination locks to secure their belongings while they are participating in physical education class, and the locks must be removed when the class period is over.*** All money and valuables should be placed in hall lockers before going to P.E. class. :

1. Turn dial two complete turns to the right then, still turning the dial to the right, stop at the first number of the combination.
2. Turn the dial to the left. Pass the first number then, still turning the dial left, stop at the second number of the combination.
3. Turn the dial to the right and stop at the third number of the combination.
4. Push up latch and locker will open.

LOSSES – THEFT

Students who find lost articles should take them to the Main Office. If an item is lost, students should first check in the Main Office, then with the appropriate supervisor. If a student suspects that an item has been stolen, he/she should report to the appropriate Assistant Principal and complete a theft form.

NATIONAL HONOR SOCIETY Membership Requirement

Section 1: Eligibility for the selection process shall be done at the end of the ***4th marking period of the previous school year.***

A. Juniors and Seniors must have a combined 92.0 average on the weighted scale. The GPA is computed by using past cumulative GPA.

B. Students must not have been involved in an incident resulting in suspension from school or serious disciplinary offenses. The list of eligible students will be examined by the appropriate Assistant Principal and a determination will be made.

Section 2: Application Procedure and Evaluations

A. Following notification of eligibility, students will complete an application packet distributed by the National Honor Society Advisor.

B. The evaluations and final determination for prospective candidates will be completed by the Faculty Council, which consists of five faculty members selected by the principal.

OFF LIMITS & UNAUTHORIZED AREAS

Students are to remain in the building at all times. Essentially a student may be in an area only if he/she has specific permission or is supervised directly by a staff member. Specific off-limits areas:

1. Stairwells except for normal traffic.
2. All copy rooms.
3. Pool area unless supervised or attending class. This includes the upstairs observation area.
4. Gymnasium unless supervised.

5. Teacher mailboxes.
6. Faculty dining room and lounges.
7. Corridors during activity period.
8. School wide intercom system.
9. Auditorium including the stage area.
10. Cafeteria unless supervised.
11. Photography room unless supervised by a staff member.
12. Weight room unless supervised by a staff member.
13. Construction Area.

Specific rules regarding academic areas will be outlined by individual teachers and area supervisors.

PASSES

Students will be issued a monthly pass at the beginning of every month. These passes are to be used whenever a student needs to leave class. Students without authorized passes are not to be in the halls during class periods. Any student caught misusing a pass will receive appropriate disciplinary action (see "misuse of hall pass" on page 16) of handbook).

Teachers have the authority to challenge any student and to ask to see his/her corridor pass and/or identification card. Teachers may also refuse passes to any student who has abused this privilege; further, administration has the authority to place any student who has abused this privilege on "pass restriction".

If a student loses his/her pass, they must report to the appropriate assistant principal to obtain a new pass. The cost of a new pass is \$2.00. The student may also be issued a central detention.

PERSONAL CONTACT

Personal contact is defined as "an inappropriate public display of affection". If this becomes a problem, students will be disciplined and parent conferences may be requested.

PHYSICAL EDUCATION

STUDENTS MAY NOT PARTICIPATE IN PHYSICAL EDUCATION WHILE WEARING CLOTHING WORN TO SCHOOL. Students will be required to CHANGE and wear approved gym attire including:

1. Gym Shorts
2. Tee Shirt
3. Sweat Suit
4. Sneakers
5. No jewelry to be worn during gym class. This includes piercings, nose rings, and / or studs.

Students not meeting these specifications as outlined by the teacher will be graded as unprepared.

Medical Excuses from Physical Education:

1. One day medical excuses may be granted provided the student brings a note from the parent on the day he/she is to be excused.
2. Longer excuses (greater than one day) require doctor's note with a diagnosis and the exact dates of the medical excuse. They are to be verified by the school Nurse ONLY.

3. Students with a short term medical excuse will attend Physical Education classes, be required to dress for P.E. class, and complete the assigned supplementary work provided by the teacher. Medically excused students must change for P.E. unless a doctor's note specifies otherwise
4. Medicals issued "until further notice" will be effective a *maximum* of 30 calendar days. After 30 days, the medical must be reviewed and/or renewed. Students may be assigned to another section of physical education.
5. Students having yearlong medical excuses may be assigned to the adaptive physical education class, provided their schedule can accommodate such a change.
6. Medical excuses from a doctor's office MUST be turned in to the nurse PRIOR to the end of the marking period for which they apply. Failure to produce a doctor's note by the end of the marking period may result in a failure for that marking period, as well as for the year.
7. An athlete excused by a doctor from a sport due to an injury will not be allowed to return to his/her sport without a release from the doctor and subsequently from the Health Office. If an athlete does not participate in physical education class for medical reasons, he/she may not participate in practice or games that day or evening. Any questions or concerns regarding an athlete's physical condition or well-being should be directed to the athletic trainer.

RENAISSANCE PROGRAM

EHTHS Renaissance is a program that is in its second official year of existence at our high school. The program was founded nationally by Jostens and educators in 1988.

EHTHS Renaissance strives to inspire the acceptance and excitement for academics and good character that is traditionally reserved for athletics. The goal of EHTHS Renaissance is to increase student performance and student and teacher enthusiasm along with raising the level of community participation in schools.

RENAISSANCE IS...

- A new way of thinking about recognizing achievement and performance.
- A cultural shift, focusing on academic performance and improvement on purpose---- not by default.
- A movement recognizing the pursuit of excellence.
- A journey---not a destination.

EHTHS RENAISSANCE MAKES IT COOL TO DO WELL IN SCHOOL!

Look for more information during the 2011-2012 school year on the Renaissance Program and its development. LOTS of EXCITING things to come for the students and staff of EHTHS! All students are welcome to join the Renaissance Club. The club currently meets every Monday after school in Room C253.

SAFETY

In the science laboratories, rigid discipline must be maintained. Instructions by the teacher will be followed carefully and exactly by the pupils. It is particularly important that all students stay in their designated areas and at their assigned stations during the entire laboratory period. This is necessary to minimize the chance of accident with resultant injury. Teacher and pupil demonstrations will be carried out with the highest regard for individual and group safety. Please review your Science Department Laboratory Safety Rules contract and related disciplinary actions with your parents.

In the Industrial Arts areas, students shall not operate any tool or machine without first having received proper instruction in the safe operation of the tool or machine and then obtaining the instructor's permission. When power machinery is in operation, all persons in the shop must wear approved safety glasses to protect their eyes and any other specific safety equipment requested by their teacher (Pursuant to N.J.S.A. 18:40-

12.1,ET.AL.). Students shall conduct themselves in such a manner that they do not endanger the personal safety of any individual in the area .

SMOKING

Smoking in the building, on buses, or on school grounds, including athletic events is prohibited at all times. Students are NOT permitted to be in possession of cigarettes, tobacco, matches, or lighters while in the school building. THESE ITEMS WILL BE CONFISCATED AND DISCARDED.

STUDENT DANCES AND THE PROM

Clubs and organizations may sponsor dances after obtaining necessary approval from the Supervisor of Student Activities. Following are general guidelines:

1. Students may NOT attend dances or the prom if they are on NO CREDIT STATUS.
2. Dances and the prom are for our high school students. Proper I.D. must be presented. Arrangements for guests must be made with the advisor of the group sponsoring the dance. All guests must be high school freshman or older. EHT alumni in good standing are permitted to attend with proper I.D.
3. Students will not be permitted to enter after an hour and a half past the starting time.
4. Students leaving the dance will not be readmitted.
5. The building will be closed to students fifteen minutes after the dance.
6. No person over 20 years old will be admitted as a guest.
7. Students from our district attending Alternative Educational Placement must have prior approval from the Egg Harbor Township High School Administration.
8. Any student who is on homebound may not attend or participate in extra-curricular activities.

STUDENT OBLIGATIONS

Students are obligated to return any school property that was issued to them. This includes, but is not limited to, books, calculators, music, athletic equipment and/or athletic wear/uniforms. Failure to return any school property may result in the following: payment for property, withholding of report card, and/or non-participation in any school activity (including athletics) until obligation is met.

STUDY HALL

Study halls are assigned classes. Any student absent from study hall without permission will be considered cutting. Study halls will be conducted like a classroom situation. Students will be expected to do work during this time period. Students may obtain passes for the library from their SUBJECT MATTER TEACHERS. Students who have passes to the library during study hall must first report to the study hall teacher.

TELEPHONE USE

Students may use the telephone in their Assistant Principal's office for emergencies only. Students may use the telephone during lunch, after obtaining a pass from a staff member, and during the activity period. Students may NOT use the telephone during class time.

VISITORS

All visitors must report directly to the front desk after entering the building. The secretary at the front desk will contact individuals whom the visitor wishes to see. Students are not permitted to bring visitors during the school day, and no visitors are permitted to see students unless there is an emergency and that individual has obtained permission from the school administrators.

ELECTRONICS

Students are not permitted to wear or carry headphones or any type of electronic device including but not limited to: I-Pods, MP3 players, Walkman, radios, CD or tape players of any kind, and/or personal video cameras after the first period bell has sounded. These devices must be turned off and placed in the student's locker or book bag during school hours. Students may not use these devices, nor can they be visible. Students may resume using these items after the eighth period. If seen during school hours, these items may be confiscated and held by the building Principal or designee until the end of the school day. The building Principal or designee will issue discipline and notify the student's parent/guardian.

Students may not carry laptop computers during school hours.

Boom boxes may not be brought to school.

Remotely Activated Paging Devices

Possession of remotely activated paging devices on school property is prohibited in compliance with 2C:33-19. No person enrolled as a student of an elementary or secondary school, knowingly and without the express written permission of the school board, its delegated authority, or any school principal, shall bring or possess any remotely activated paging device on any property used for school purposes, at any time and regardless of whether school is in session or other persons are present. A violation of this section shall be a disorderly persons offense. No permission to bring or possess any remotely activated paging device on school property shall be granted unless and until a student shall have established to the satisfaction of the school authorities a reasonable basis for the possession of the device on school property.

This section shall not apply to any student who is an active member in good standing of a volunteer fire company or first aid, ambulance or rescue squad provided that (1) the student is required to respond to an emergency and (2) a copy of the statement by the chief executive officer of the volunteer fire company or first aid, ambulance or rescue squad authorizing the possession of the paging device is in the possession of the student at all times while that student is in possession of the remotely activated paging device.

WATER

Research in Brain Compatible Learning supports the importance of water consumption by students to enhance their ability to learn. Students are permitted to have water in clear plastic bottles ONLY in their classrooms during the day.

STUDENT ACTIVITIES & ATHLETICS

PHILOSOPHY

Egg Harbor Township High School will offer a wide range of athletics, clubs, and organizations. The Board of Education believes that student activities contribute to the mental, physical, and social growth of the individual participant.

Experience in student activities will be designed to help meet the leisure, recreation, social and emotional interest and needs of all students. It is important that a student participates in activities, but each individual must realize that activities cannot be permitted to keep a student from fulfilling his or her academic potential.

It is the goal of all activities and athletics to have all students not only explore their individual interests, but to develop values of dedication, responsibility, and good sportsmanship.

All students will follow rules established by the school, advisors, and coaches, and will be aware that they are representatives of Egg Harbor Township High School.

ELIGIBILITY FOR PARTICIPATION IN SPORTS AND ACTIVITIES

1. The New Jersey State Board of Education adopted revised regulations addressing high school graduation. The classes of 2012 and 2013 (Juniors and Seniors) will be required to have 115 credits for graduation. The classes of 2014 and 2015 (Sophomores and Freshman) will be required to have 120 credits for graduation.
2. In order to be eligible for fall sports and activities, the sophomore, junior, and senior class students (classes of 2012 to 2014) must have passed 30 credits on his/her final report card (June), or through summer school. Freshmen (class of 2015) are automatically eligible through promotion for the fall season.
3. If students are ineligible as of September 1, students cannot regain eligibility until the end of the first semester.
4. Students must pass 6 classes (30 credits) in the first marking period to maintain eligibility for the remainder of the fall season.
5. In order to participate in winter sports and activities, sophomore, junior, and senior class students (classes of 2012, 2013, 2014) must be eligible as of September 1 and must have passed six **(6)** classes (30 credits) at the end of the 1st marking period. In order to participate in winter sports and activities, freshman students (class of 2015) must have passed six **(6)** classes (30 credits) at the end of the 1st marking period.
6. In order to maintain eligibility for the winter season, students must pass 6 classes (30 credits) in the second marking period.
7. In order to participate in spring sports and activities, students must pass 6 classes in the second marking period as well as pass 6 classes in the first semester (average of first and second marking period).
8. In order to maintain eligibility for the spring season, students must pass 6 classes (30 credits) in the third marking period.

ACTIVITY PERIOD

The activity period, conducted on Mondays, Tuesdays, Wednesdays, and Thursdays, immediately following eighth period, is designed to provide students with the opportunity to receive academic assistance, to conduct research, and to participate in co-curricular activities. Central detentions and teacher detentions are also conducted at this time. Students who attend a meeting, make up work, or receive help during this time period, must remain with their supervising teacher for the ENTIRE activity period. Students will NOT be dismissed before 3:10 p.m. Students who complete their assignments early will remain under the supervision of their teacher until dismissal, UNLESS they have a pass from to report to another teacher or coach.

Following are general guidelines for activity period.

1. Students MUST report to their destination by the late tone (2:13 p.m.).
2. Students may NOT stay for activity period unless they are under the supervision of a specific staff member. Students who stay after school without supervision will be subject to disciplinary action.
3. Students will remain with their supervising teacher until the end of the activity period.

TRIP CERTIFICATION

Students who are ineligible academically and/or are on NO CREDIT STATUS are prohibited from attending any trip that requires missing school time. This includes all classes, band, choir, and drama.

- A. Trips involving non-refundable deposits are included in this provision.
1. Students participating in this type of trip must be informed when they register for trips that ineligibility may necessitate forfeiture of deposit.
 2. A week before the last day for refunds, the activity advisor will ascertain that all those registered for the trip are eligible. Those who are not eligible will immediately be removed from the trip and their refund will be processed.

Determination of eligibility under any of the above provisions may be appealed to the High School Principal who shall consider any mitigating or extenuating circumstances.

Students who are academically ineligible and/or are on NO CREDIT STATUS are prohibited from participating in athletics and activities. These activities include any trip that is not part of the classroom instruction.

ATHLETIC DEPARTMENT

For daily updated High School Athletic Schedules please call: (609) 653-0100 ext. 1660 and press 2

For schedules online please go to: www.eht.k12.nj.us Click on High School; click on EHT Sports Schedules, or you can go to www.highschoolsports.net

All contests are subject to change with respect to weather, time conflicts, site, or other mutual agreements between the schools involved. The athletic director will make such changes with the consent of the principal.

Below is a list of the athletic and activity programs that have been previously offered at Egg Harbor Township High School.

Fall Season

Cheerleading
Boys Cross Country
Girls Cross Country
Field Hockey
Football
Boys Soccer
Girls Soccer
Girls Tennis

Winter Season

Cheerleading
Boys Basketball
Girls Basketball
Swimming
Winter Track
Wrestling

Spring Season

Baseball
Boys Crew
Girls Crew
Golf
Softball
Boys Tennis
Boys Track
Girls Track
Boys Lacrosse
Girls Lacrosse

STUDENT ACTIVITIES

Academic Challenge Club
Band
Choir
Class of 2011 Senior Class Officers
Class of 2012 Junior Class Officers
Class of 2013 Sophomore Class Officers
Class of 2014 Freshman Class Officers
D.E.C.A.
Drama Club
Environmental Club
FBLA
Garden Club
Ice Skating Club
Indoor Guard
Interact Club
Intramural Weight Training
Jazz Ensemble
Key Club
Media Club
Mock Trial
Multi-Cultural Society (African-American, Latin, French, and
Hispanic Clubs)
Musical
National Honor Society
National Honor Society-Special Areas (German, Spanish, and
Music)
New Jersey Science League (Biology, Chemistry, and
Physics)
Newspaper

Renaissance Club
S.A.D.D.
School Store
Student Council
Student Mediation
Thespian Club
Visual Arts
Yearbook

REVISED
Board Approved 3-22-11

EGG HARBOR TOWNSHIP
SCHOOL DISTRICT
SCHOOL CALENDAR 2011-2012

REVISED
Board Approved 3-11-22

September

M	T	W	T	F	
			1	2	2 Staff in service
5	6	7	8	9	5 Labor Day
12	13	14	15	16	6 First Day Students
19	20	21	22	23	29 Rosh Hashanah
26	27	28	29	30	

Teachers 19 - Students 18

October

M	T	W	T	F	
3	4	5	6	7	7 In-Service Day
10	11	12	13	14	10 Columbus Day
17	18	19	20	21	
24	25	26	27	28	
31					

Teachers 20 - Students 19

November

M	T	W	T	F	
1	2	3	4		10 & 11 NJEA Convention
7	8	9	10-11		School Closed
14	15	16	17	18	23 Abbreviated Day
21	22	23	24-25		24-25 Thanksgiving Recess
28	29	30			

Teachers 18 - Students 18

December

M	T	W	T	F	
			1	2	23 Abbreviated Day
5	6	7	8	9	26-30 Winter Recess
12	13	14	15	16	
19	20	21	22	23	
26	27	28	29	30	

Teachers 17 - Students 17

January

M	T	W	T	F	
2	3	4	5	6	3 School Reopens
9	10	11	12	13	16 Dr. Martin Luther King's Birthday
16	17	18	19	20	
23	24	25	26	27	
30	31				

Teachers 20 - Students 20

February

M	T	W	T	F	
			1	2	17 In-Service Day
6	7	8	9	10	20 President's Day
13	14	15	16	17	
20	21	22	23	24	
27	28	29			

Teachers 20 - Students 19

March

M	T	W	T	F	
			1	2	16 In-Service Day
5	6	7	8	9	
12	13	14	15	16	
19	20	21	22	23	
26	27	28	29	30	

Teachers 22 - Students 21

April

M	T	W	T	F	
2	3	4	5	6	5 Abbreviated Day
9	10	11	12	13	6-13 Spring Break
16	17	18	19	20	
23	24	25	26	27	
30					

Teachers 15 - Students 15

May

M	T	W	T	F	
1	2	3	4		28 Memorial Day
7	8	9	10	11	
14	15	16	17	18	
21	22	23	24	25	
28	29	30	31		

Teachers 22 - Students 22

June

M	T	W	T	F	
			1		15 Last Day Students
4	5	6	7	8	15 Last Day Teachers
11	12	13	14	15	Last Four days of Academic year - 1/2 days for students
18	19	20	21	22	
25	26	27	28	29	

Teachers 11 - Students 11

Total Student Days 180
Total Teacher Days 184

— = no school
// = abbreviated day students.
○ = staff only

School Closings Due to Weather Related Conditions or Other Emergencies Will be Made-up at the End of the School Year and/or During Spring Break, Trip Insurance is Recommended for Vacation Plans

Typically you will receive a Blackboard connect phone call however for additional closing information you can turn to TV and/or local radio broadcast. Abbreviated days will be announced for staff in-service, parent conferences and any additional days that might be needed.

Egg Harbor Township High School

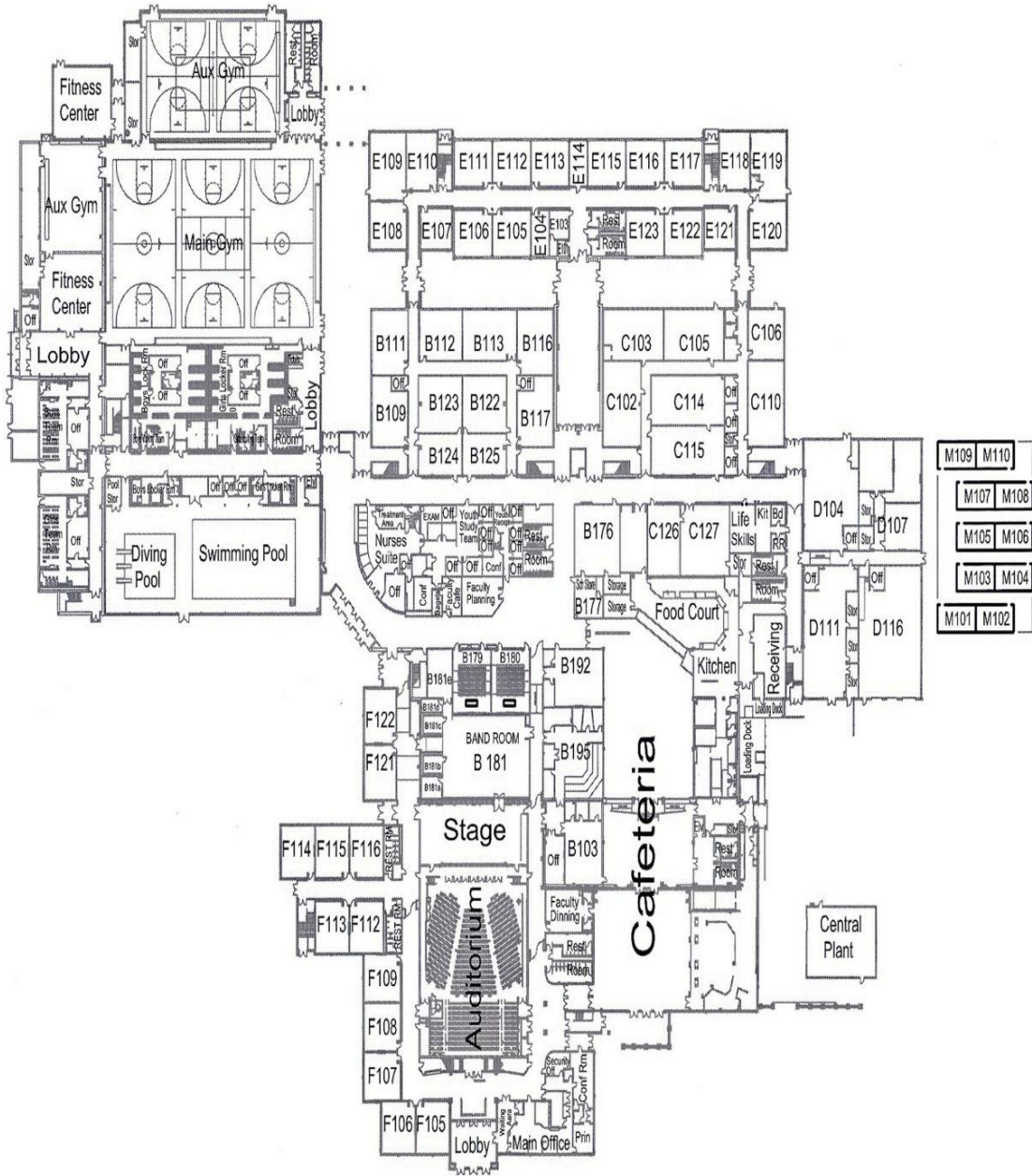

1st Floor

Egg Harbor Township High School

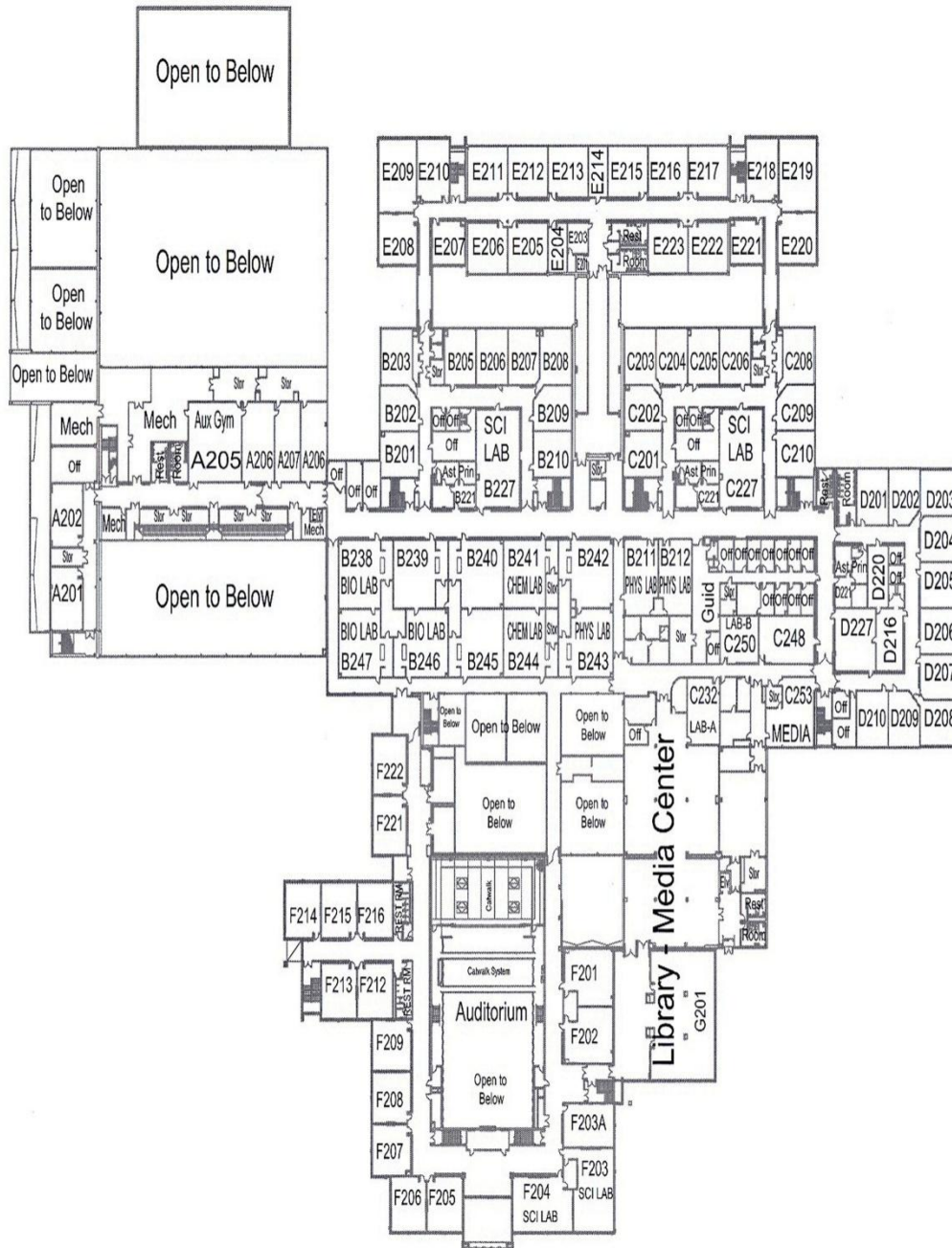

2nd Floor

ALPHABETICAL INDEX

Academic Honesty Policy	41
Activity Period	17; 51
Administrator's Welcome	9
Affidavits, Proof of Residency/Guardianship	33
Athletics/Athletic Department	52-53
Attendance	36-40
Appeals	38
Excused Absences	36-37
No Credit - Credit Completion	38-39
Statement of Attendance Policy	36
Total Loss of Course Credit	38
Vacation - Family	37
Automobiles	17
Bell Schedule	11-12
Cafeteria/Commons Area Guidelines	17; 41
Card Playing	41
Cellular Phones	17
Classroom Telephones	42
College Visitations	37
Computer Misuse	17-18
Conduct Potentially Dangerous	18
Dances, Student	49
Discipline	13-25
Central Detention	13
Code of Infractions	17-25
Out-of-School Suspension	16
Probation/Behavior Contracts	16
Saturday Detentions	14-15
Teacher Detention	713
Disrespect/Defiance of Authority	18
Dress Code	18; 42-43
Drugs/Alcohol Policy and Procedures	18-19
Eagle Academy	34-35
Elevator	43
Eligibility	50-51
Emergency Closing	43
Emergency Drills	43
Failure to Follow Procedure	20
False Alarms	20
Fire Alarms	43-44
Fighting	20
Fireworks	20
Forgery	20
Grading Procedures	33
Guardianship, Proof of	26-35
Guidance Services	26-35
Class Rank	29-30
Course Requirements	27-28

Graduation Requirements	27-28
Honor Roll	30
Interim Progress Reports	29
Occupational Career Opportunities	33
Parent Portal	29
Post Secondary Education	31-32
Report Cards	29
Testing Program	31
Working Papers	33
Harassment	20-21
Health Services	44-45
History of School	9
Home Instruction	37
Homeroom	45
Identification Badges	21
Illegal Absence from Class Policy	21-22
Illness	44
Immunization	44
Late Sign-in Policy	22; 40
Lateness to Class	22
Lavatories	45
Leaving Class without Permission	22
Library/Media Center	45
Lockers	45-46
Lost and Found	46
Mace	22
Medications - Prescriptions	44
Misconduct/Disruptive Behavior	22
National Honor Society	46
Obligations, Student	49
Off Limits Areas	46-47
Passes	47
Personal Contact	47
Physical Education	47-48
Attire	47
Medical Excuses	47-48
Physical Examination	45
Profanity	23
Pupil Records	30-31
Racial/Ethnic Slurs	23
Removal from Saturday Detention	15; 23
Residency, Proof of	33
Safety	45
School Bus Behavior	23
School Calendar	54
School Maps	55-56
Sexual Harassment	23
Signing In, Out	40
Smoking	23-24; 48
Statement of Non-Discrimination	9
Student Activities	53
Student Assistance Program	34
Study Hall	49

Tardiness and Early Release	39-40
Telephones	42; 49
Telephone Directory	10
Theft	24; 46
Trip Certification	51-52
Truancy	24
Unauthorized Area	24; 46-47
Unauthorized Possession of School Forms	24
Unauthorized Sales	24
Vandalism	24
Violence/Threats toward Staff Member	24
Visitors	49
Water	50
Weapons	25
Withdrawal from School	33